



### Safety Instructions

1, 2, 3, 4, 7, 9, 11, 12, 13, 14, 16, 17, 18, 19, 21, 33, 34



Info

[www.paulmann.com](http://www.paulmann.com)

Paulmann Licht GmbH  
Quezinger Feld 2  
31832 Springe  
Germany

[www.paulmann.com](http://www.paulmann.com)

Art.-Nr. : 709.62



(+326)PPN 11/18

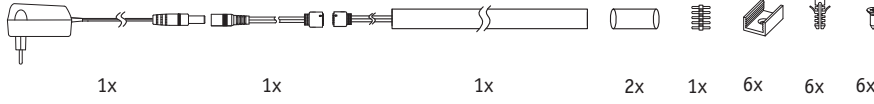

A1 A2



Safety Instructions  
Nr. 7, 10

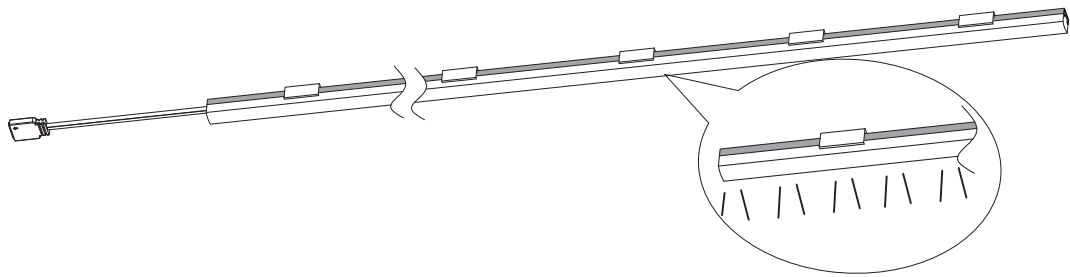
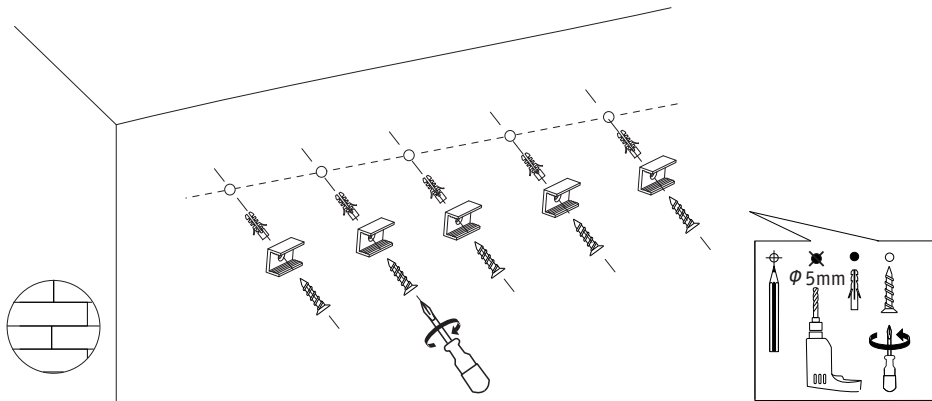

A1 A2



Safety Instructions  
Nr. 7, 10

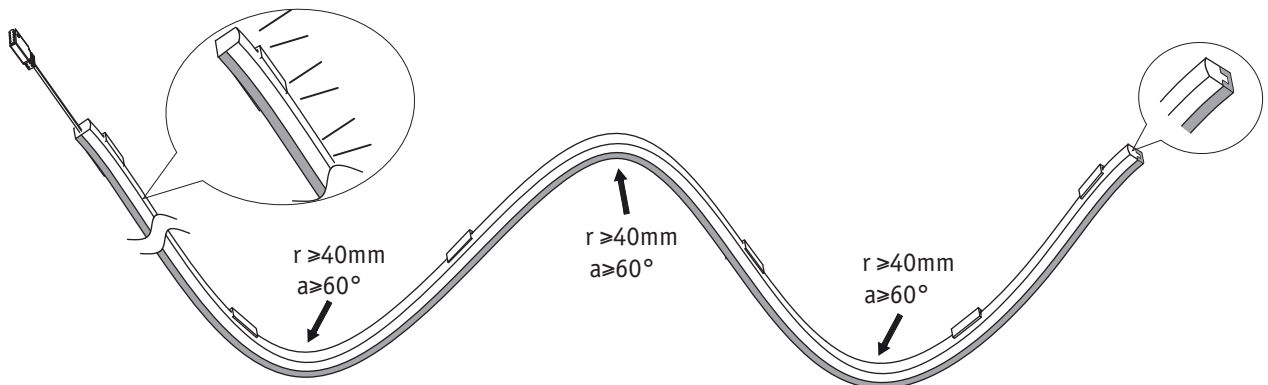
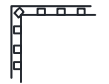
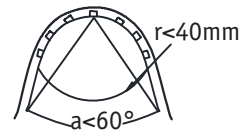
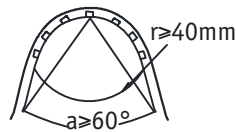
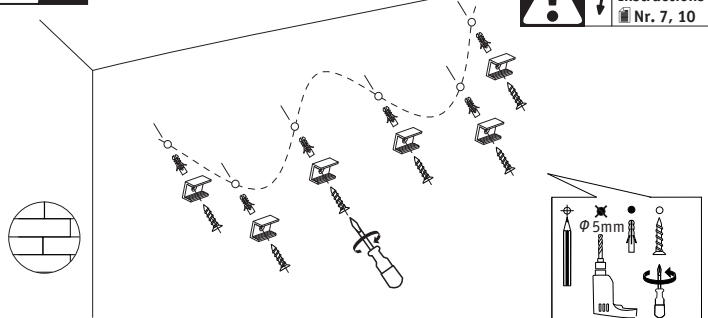

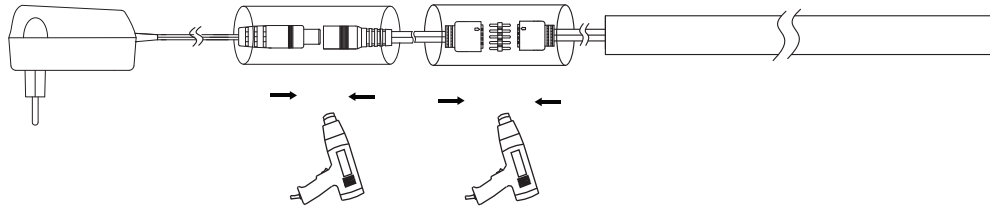

IP20

IP44

IP67

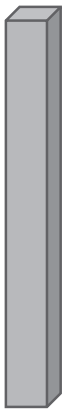
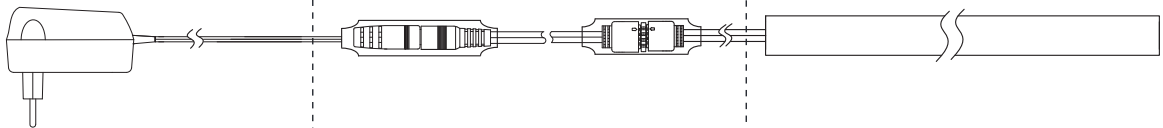

Off

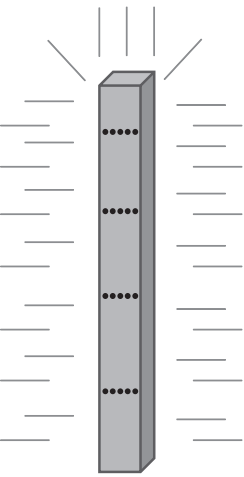

On

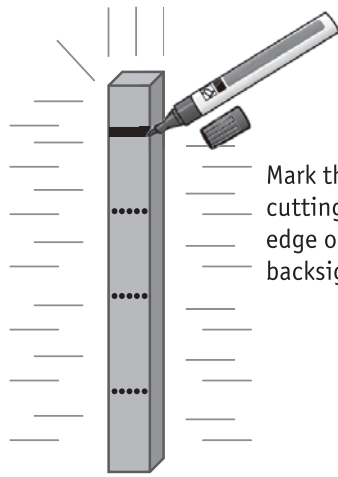

On

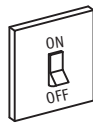

Mark the cutting edge on the backsight



Off



Cutable every 3,3cm

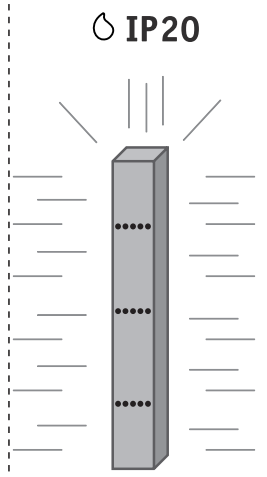

On

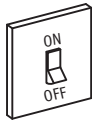

IP20

