

Canopy

by Mater

mater

For this product you will need two screws and two plugs in addition to the components that are included.

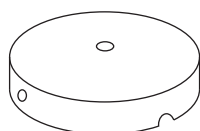
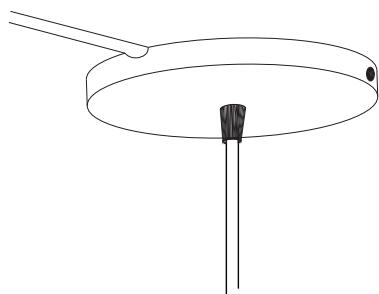

1 x ceiling cap



1 x cord grip sleeve



2 x screws

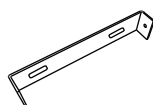

1 x ceiling bracket



1 x cord grip



1 x bolt

1

Drill holes and insert wall plugs and screw the bracket into the ceiling.

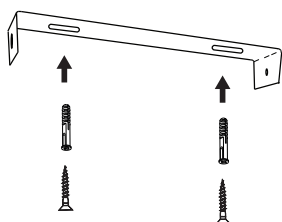

2

Pull the cord grip sleeve on to the cord as shown.

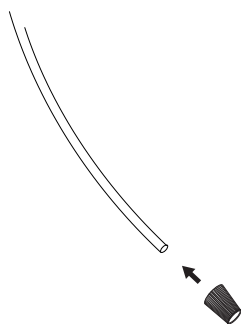

3

Fix the cord grip and bolt on to the ceiling cap.

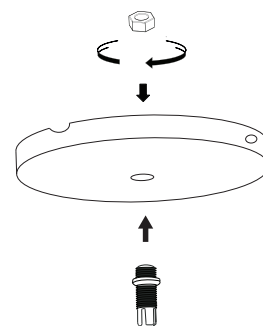

4

Pull the pendant's cord at the desired length, fix the cord grip sleeve in place and tighten.

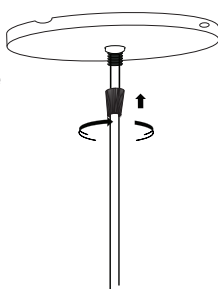

5

Use the supplied screws to seal the ceiling cap to the bracket mounted in the ceiling.

