

Artemide®

Eclisse

design
V. Magistretti

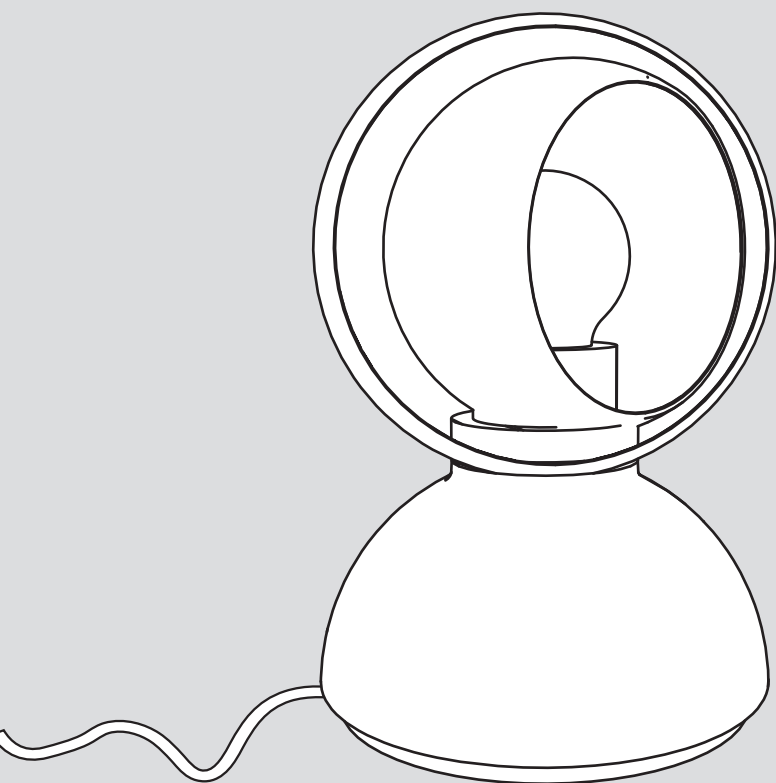



i

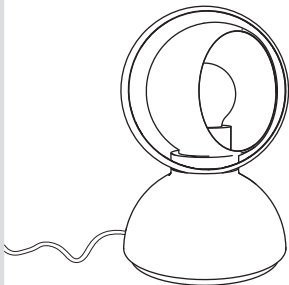
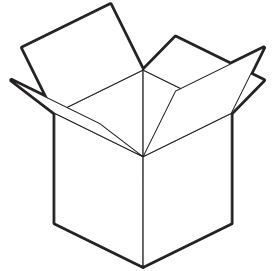
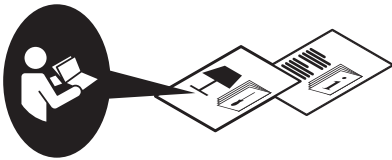
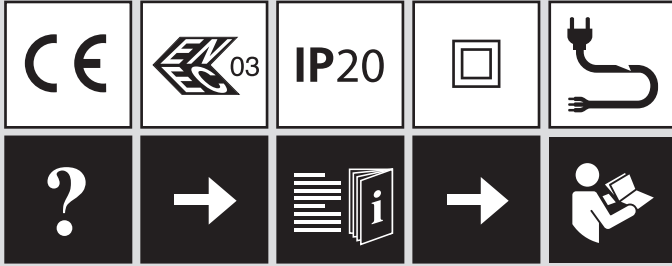

1

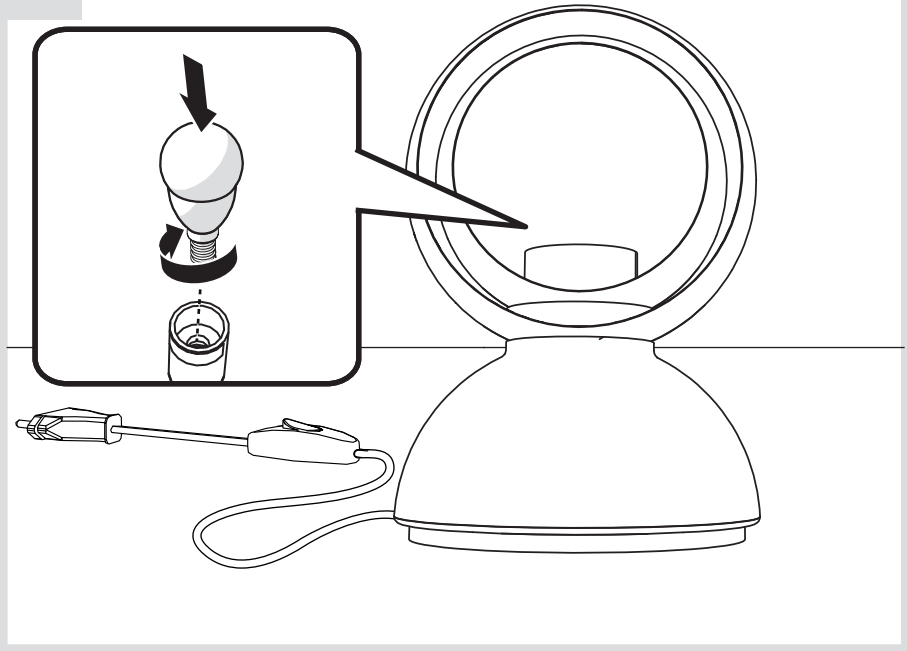

2

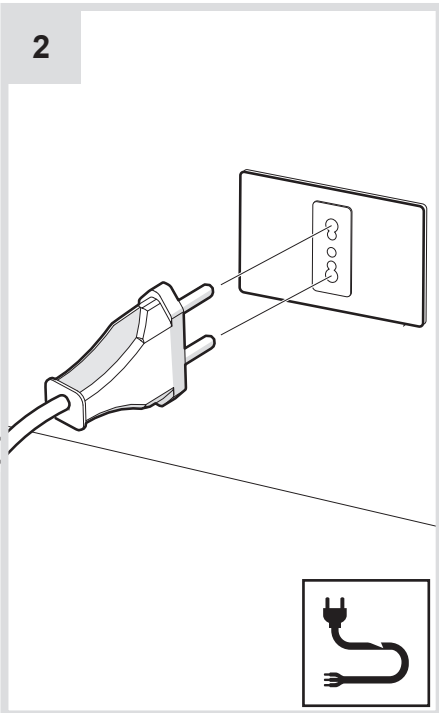

3

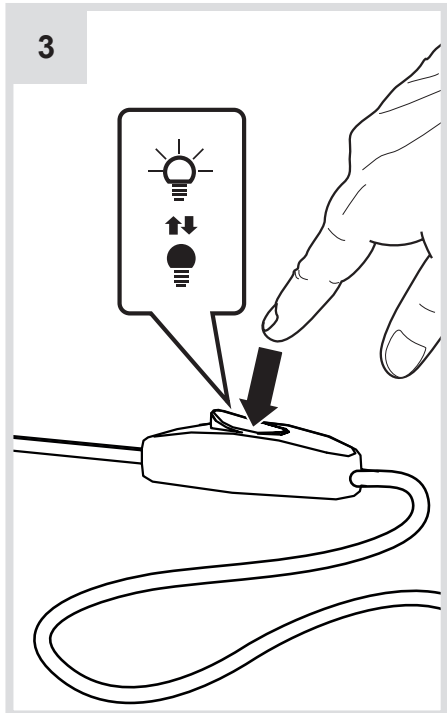

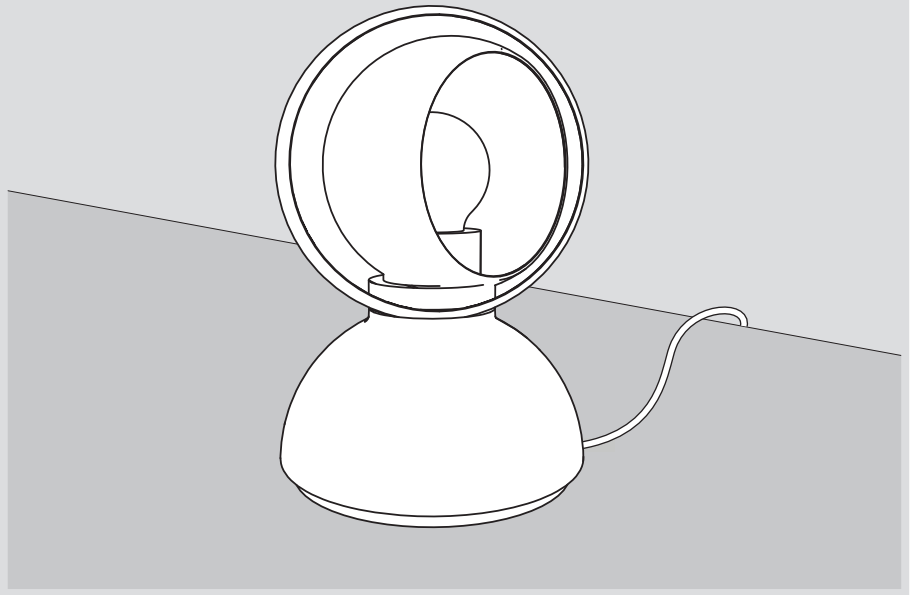

i

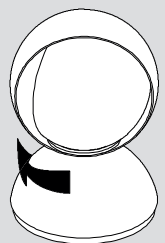
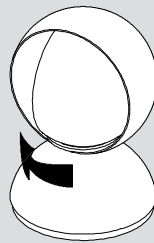
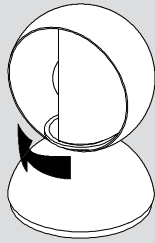
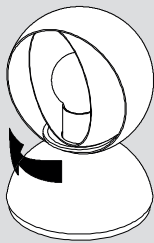

i

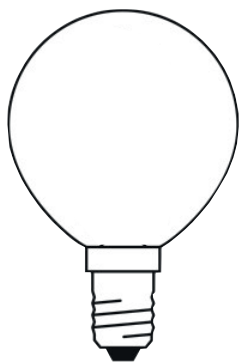

MAX 25W - E14

Halo: HSG - 250 lm

LED: DRBP - 250 lm

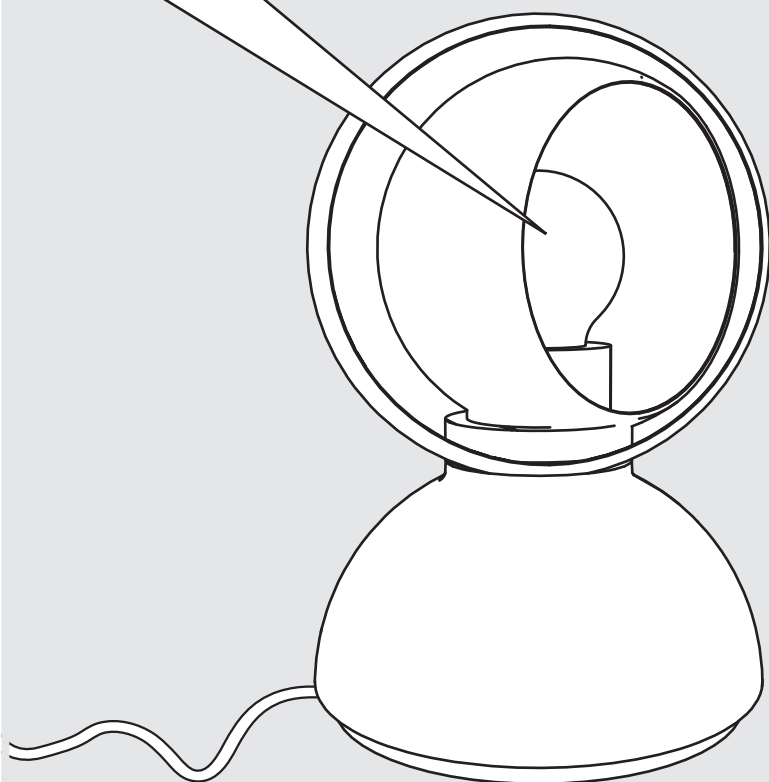

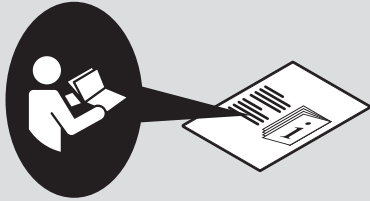

Artemide®



Artemide

via Bergamo, 18
20010 Pregnana M.se (MI)
ITALIA

tel. +39 02 935 181
fax +39 02 935 90 254
fax +39 02 935 90 496

www.artemide.com

VAT IT00846890150

cod. Y513000663