











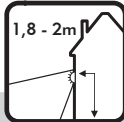
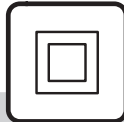
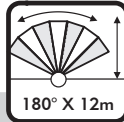

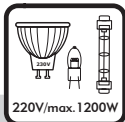
# PRODUCT ATTACHMENT

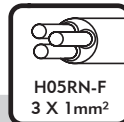
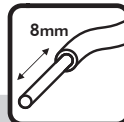
## Use safety instructions 1

10.017.10  
10.017.11

 1	 2	 1,8 - 2m 4	 8	 180° X 12m 12	 10sec 7min 14
 15	 220V/max. 1200W 17	 E27- 300W 20	 E27- 1200W 21	 H05RN-F 3 X 1mm <sup>2</sup> 25	 8mm 26
 IP44 35					 

220-240VAC/50Hz.



10.017.11



10.017.10

smartwares  
Europe  
Swaardvenstraat 65  
5048 AV Tilburg  
The Netherlands  
[www.smartwares.eu](http://www.smartwares.eu)

**S**

10.017.10  
10.017.11

**PRODUCT ATTACHMENT**  
**Use safety instructions 1**

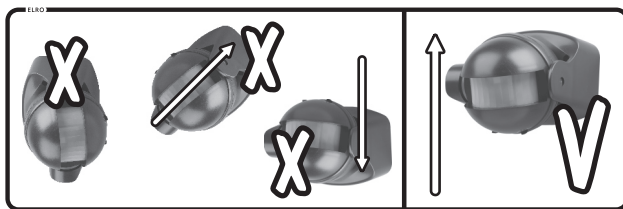
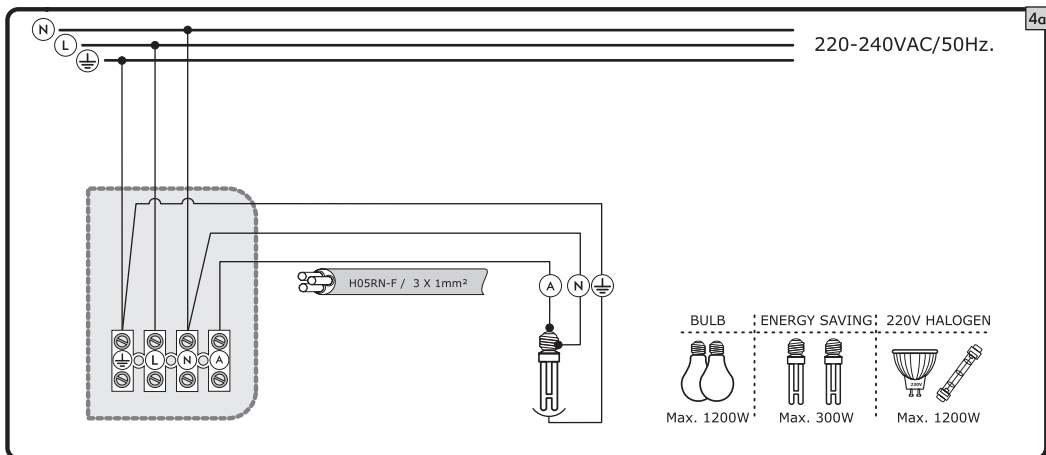
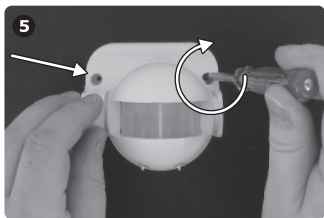
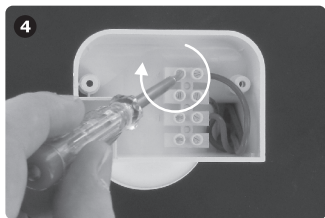
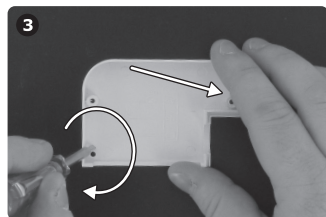
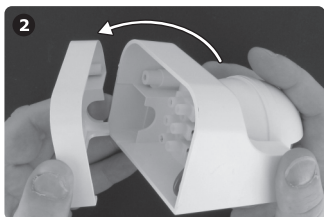
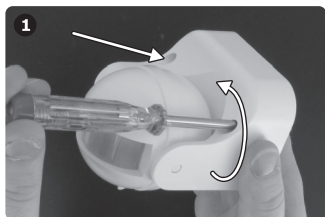

**Test detector:**

- 1- **TIME** → —
- 2- **LUX** → ☀️
- 3- ⏰ **60 seconds**

**Use detector**

**7min** 🕒 **10sec** →

**TIME** (rotary switch with - and +)    **LUX** (rotary switch with ☀️)