

Dancing Pendant by Iskos Berlin

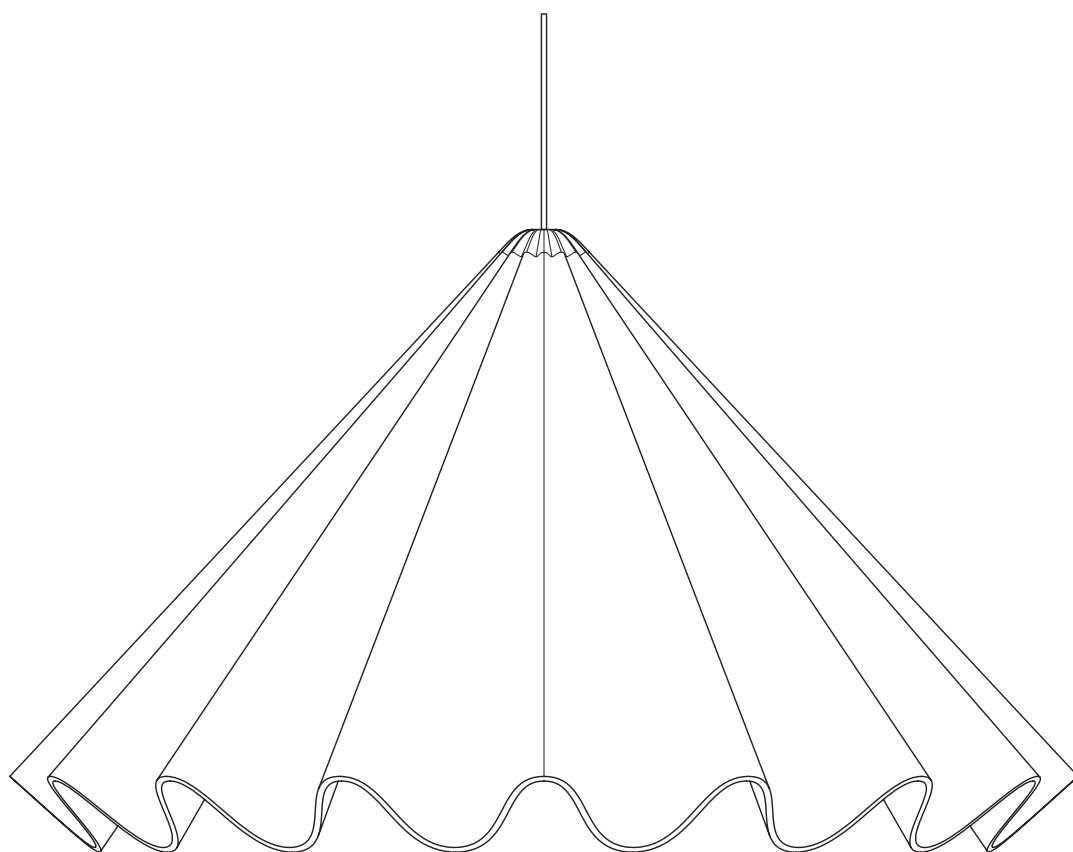

MENU

Congratulations

Congratulations on your new Dancing Pendant by Iskos-Berlin. The special lampshade is designed in the material PET felt. PET felt is sound-absorbing and contributes to a good environment in the house. The recyclable lamp is therefore an ideal lighting piece for your home.

Component overview

1 pc dancing pendant with white canopy and E27 lamp holder

Technical Details

E27 lamp holder

Maximum 60 Watt bulb

300 cm white textile cord

Care Instructions

Clean only by vacuum cleaning with a soft-brush attachment. Do not rub or use a cloth.

WARNING

The Dancing Pendant weighs a total of 2.5 kg. Consider the load capacity of the ceiling.

Use screws and wall plugs that are suitable for the walls in your home. If you are uncertain as to which types of screws/wall plugs to use, you should ask your hardware store.

BE SURE THE ELECTRICITY TO THE WIRES YOU ARE WORKING ON IS SHUT OFF; EITHER THE FUSE IS REMOVED OR THE CIRCUIT BREAKER IS TURNED OFF.

Please check the specific rules for electrical installation work in your country.

Some countries may require an authorised electrical contractor.

Important

If you have any problems regarding the electrical installation, contact a certified electrician. Always shut off power to the circuit before starting installation work. The external flexible cable or cord of this luminaire cannot be replaced. If the cord is damaged, the luminaire shall be destroyed.

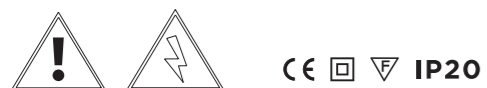

Correct Disposal of this product

This marking indicates that this product should not be disposed with other household wastes throughout the EU. To prevent possible harm to the environment or human health from uncontrolled waste disposal, recycle it responsibly to promote the sustainable reuse of material resources.

To return your device, please use the return and collection system or contact the retailer where the product was purchased. They can take this product to environmentally safe recycling.

1

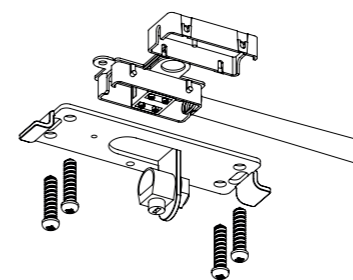

2

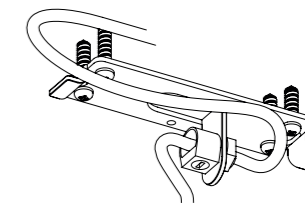

3

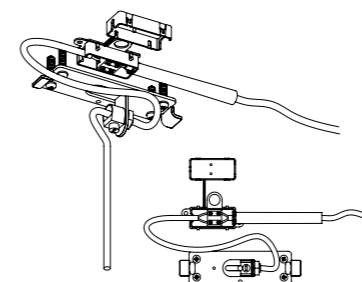

4

