

**11. Montageskizze / Assembly drawing / Schéma de montage / Montageset / Szkic montażu /  
 Monteringstegning**
**9619080**

 10W LED  
 230 V ~ 50 Hz

**Bestimmungsgemäße Verwendung**

Applications / Utilisation conforme / Beoogd gebruik / Użycie zgodnie z przeznaczeniem / Tiltentkt/tiltænkt anvendelse

**(D)** Ortsfeste Verwendung an Wegen/in Beeten im Außenbereich  
**(GB)** Provided for stationary outdoor use on trails / flower beds  
**(F)** Pose fixe le long des allées/des parterres de plantes, à l'extérieur

**(NL)** Vast gebruik langs paden en bloembedden buitenshuis  
**(PL)** Do montażu stacjonarnego na zewnątrz przy drogach/grządkach  
**(N/DK)** Til stasjonært/stationær bruk/brug på veier/veje og i bedd/bed utendørs/udendørs

**Verwendete Symbole**

Safety Precautions / Symboles utilises / Gebruikte symbolen / Stosowane symbole / Anvendte symboler

IP 54

**Lieferumfang**

Package contents / Contenu de la livraison / Bij de levering inbegrepen / Zakres dostawy / Leveringsomfang

<ul style="list-style-type: none"> <li>• 1 Wegeleuchte</li> <li>• Montagematerial</li> <li>• Montageanleitung</li> </ul>	<ul style="list-style-type: none"> <li>• 1 Street and path light</li> <li>• Installation hardware</li> <li>• Mounting instructions</li> </ul>	<ul style="list-style-type: none"> <li>• 1 Borne lumineuse</li> <li>• Matériel de montage</li> <li>• Instructions de montage</li> </ul>
<ul style="list-style-type: none"> <li>• 1 Padverlichting</li> <li>• Monteringsmateriale</li> <li>• Montagehandleiding</li> </ul>	<ul style="list-style-type: none"> <li>• 1 Słupek oświetleniowy</li> <li>• Elementy montażowe</li> <li>• Instrukcja montażu</li> </ul>	<ul style="list-style-type: none"> <li>• 1 Gatelys/Gadelys</li> <li>• Monteringsmateriale</li> <li>• Brukerveiledning/ Brugervejledning</li> </ul>

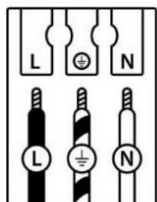
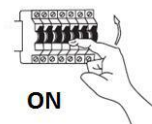
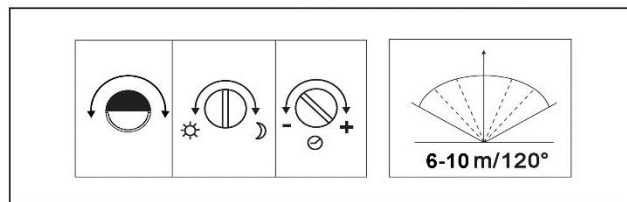
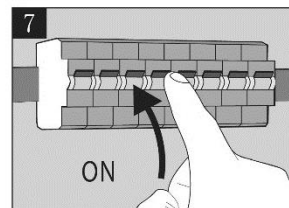
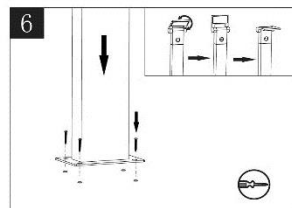
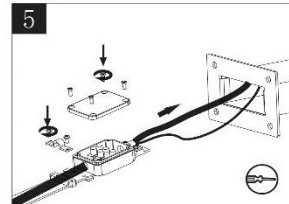
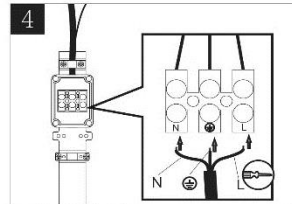
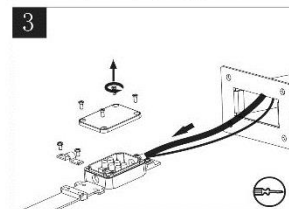
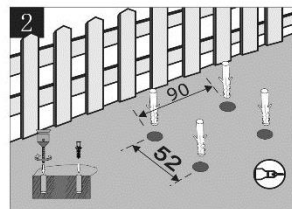
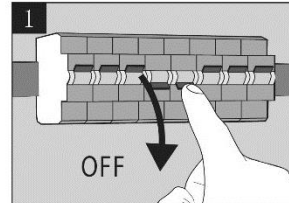
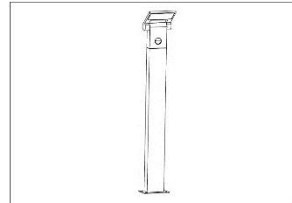
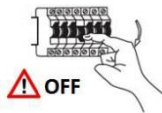

	(D) Deutsch	(GB) English	(F) Français	(NL) Nederlands	(PL) Polski	(N) Norsk / (DK) Dansk
<b>L</b>	Stromführender Leiter	Live conductor	Conducteur	Spanningvoere nde draad	Przewód prądowy	Strømførende leder
	Schutzleiter	Earth conductor	Conducteur de protection (terre)	Aardkabel	Przewód uziemiający	Jordledningen
<b>N</b>	Neutralleiter	Neutral conductor	Conducteur neutre	Nulleider	Przewód zerowy	Nøytralleider/ Neutralleider