



TERESA RANGE

DOWNLIGHT
DECKLIGHT

MODEL:
Teresa 90
Teresa 160
Teresa 260



MADE IN ITALY
www.fumagalli.it



UK

CAUTION! Installation and maintenance procedures must be carried out only after switching off the electricity supply. Use energy saving lamps only. If present, fit the gasket properly inside the diffuser, to ensure the IP protection. Fittings not suitable for being covered with thermally insulating material. Fumagalli Srl accepts no responsibility whatsoever for damages caused by incorrect installation, misuse or when used by combining it with non-original spare parts. If in doubt, consult a qualified electrician. Keep the instructions.



I

ATTENZIONE! L'installazione e la manutenzione dell'apparecchio devono essere eseguite solo dopo aver disinserito l'energia elettrica. Utilizzare solo lampade a basso consumo. Laddove presente, assicurarsi del corretto posizionamento della guarnizione all'interno dell'apparecchio al fine di garantire il grado di protezione IP. Apparecchi non idonei ad essere ricoperti con materiale termicamente isolante. Fumagalli Srl non accetta responsabilità per danni causati da incorretta installazione, incorretto uso o dall'utilizzo di parti di ricambio che non appartengono al prodotto originale. Per qualsiasi dubbio, consultare un elettricista qualificato. Conservare le istruzioni.



F

ATTENTION! Les opérations de montage et d'entretien ne doivent être effectués que lorsque le courant électrique est coupé. Utiliser seulement des ampoules à économie d'énergie. Si présent, assurer le positionnement correct de la joint dans l'appareil, afin de garantir le degré de protection IP. Les luminaires ne conviennent pas pour être recouverts d'un matériau isolant thermique. Fumagalli Srl n'accepte pas aucun responsabilité pour toutes les dommages causés par une mauvaise installation, par un utilisation incorrecte ou par l'utilisation des pièces de rechange qui ne sont pas originales. En cas de doutes, faites appel à un électricien qualifié. Conserver les instructions.



E

PRECAUCIÓN! Lleve a cabo la instalación y mantenimiento tras cortar la tensión de la instalación eléctrica. Use únicamente lámparas de ahorro. Si se incluye, juste correctamente el aro de goma con el producto para asegurar la protección IP indicada en el producto. Lámparas no adecuadas para ser cubiertas con material aislante térmico. En cualquier caso Fumagalli Srl no aceptará responsabilidad alguna por instalación incorrecta, mal uso o por su uso con accesorios no originales del fabricante. En caso de duda consulte con un electricista cualificado. Guarde estas instrucciones.

A

تحذير! اجراءات التركيب والصيانة يجب تنفيذها الا بعد إيقاف تشغيل التيار الكهربائي. قم باستخدام المصابيح الموفرة للطاقة فقط. إذا كان موجوداً، قم بتركيب الحشوة كما ينبغي بصورة صحيحة داخل الغطاء المخصص لتشتت الضوء بشكل متساوي، لضمان الحماية من تنفق الماء. يجب عدم تغطية وحدات الإنارة بأي مواد عازلة للحرارة. الشركة المصنعة فوماجالي لا تقبل أي مسؤولية عن الأضرار الناتجة عن التركيب غير الصحيح، سوء الاستخدام، أو عند إستخدام قطع غيار غير أصلية عند الجمع. إذا التابك أي شك، قم باستشارة كهربائي مختصن. قم بتتبع التعليمات.

TERESA 90 - GU10 LED

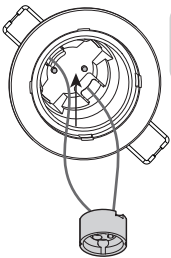

MAX 6 W
MAX 250 V
50/60 Hz

H05 RN-F 30mm
Ø 6 mm

FUMAGALLI LAMP
GU10 LED
F

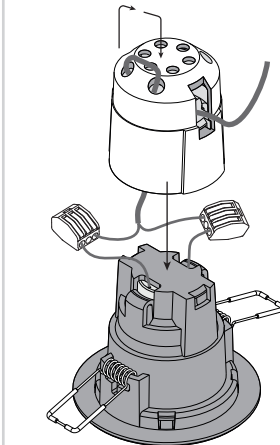
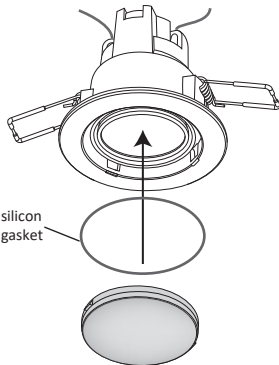
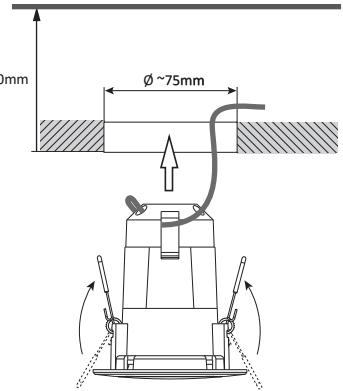

single connection

cascade connection

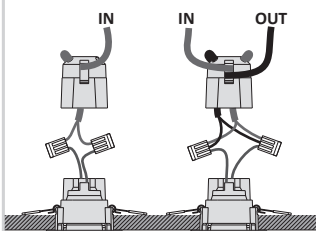

lamp replacement

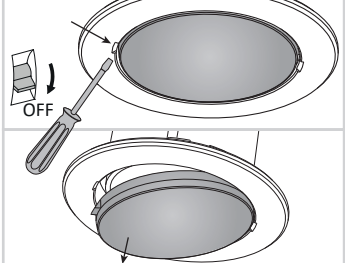

TERESA 160 - GX53 LED



MAX 10 W
MAX 250 V
50/60 Hz

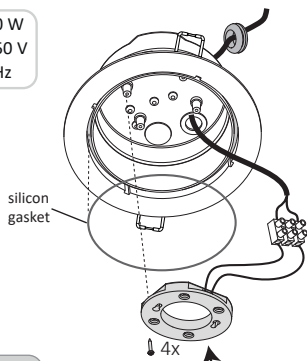

FUMAGALLI LAMP

GX53
LED
E



TERESA 260 - GX53 LED



MAX 23 W
MAX 250 V
50/60 Hz

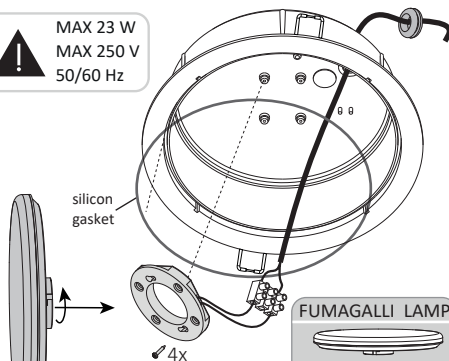

FUMAGALLI LAMP

GX53 LED

F E
7 W 11 W
18 W

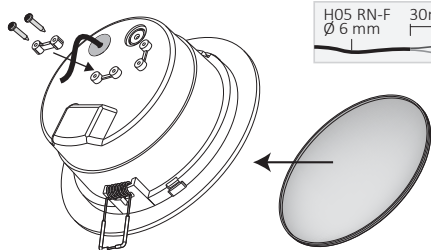

H05 RN-F 30mm
Ø 6mm

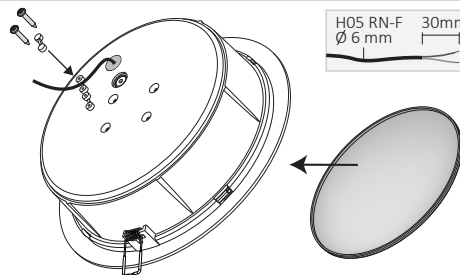

H05 RN-F 30mm
Ø 6mm

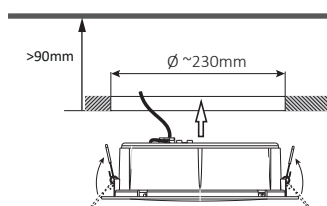
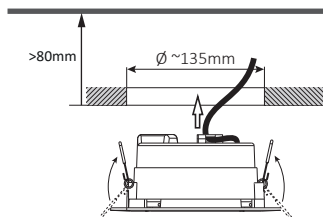

single connection

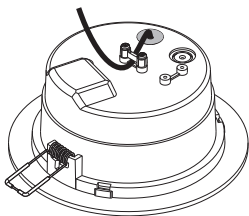

cascade connection

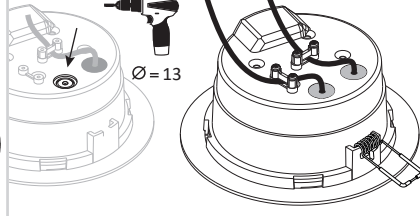

Ø = 13

lamp replacement

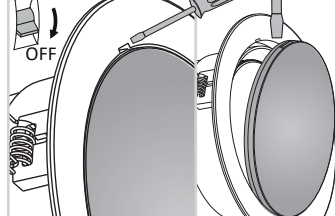

[WARRANTY] Fumagalli products are CE marked. Declaration CE of conformity available at www.fumagalli.it/company. The warranty of Fumagalli product is of 1 year. In case of evident manufacturing faults, Fumagalli Srl according to his unquestionable judgement, will proceed to the repair or the replacement. This warranty does not cover any cost neither regarding the transport, nor the uninstallation, nor the re-installation, nor the dismantlement of the material.

[GARANZIA] I prodotti Fumagalli sono marchiati CE. La Dichiarazione CE di conformità è disponibile su www.fumagalli.it/company. I prodotti Fumagalli godono di una garanzia di legge di 1 anno. Nel caso di evidenti difetti di fabbricazione Fumagalli Srl, a suo insindacabile giudizio, procederà alla sua riparazione o sostituzione. In nessun caso l'acquirente potrà reclamare rimborsi o spese sostenute per l'installazione, la disinstallazione, il trasporto o lo smaltimento del materiale.