

# SHAHIN WALL MOUNTING INSTRUCTIONS

NB! When handling this lamp please always handle with care as this is a fragile product.

NB! Always read the mounting instructions before mounting. If you do not feel comfortable please call a qualified electrician.

NB! For best light distribution always use frosted bulbs. Max 40W in total.

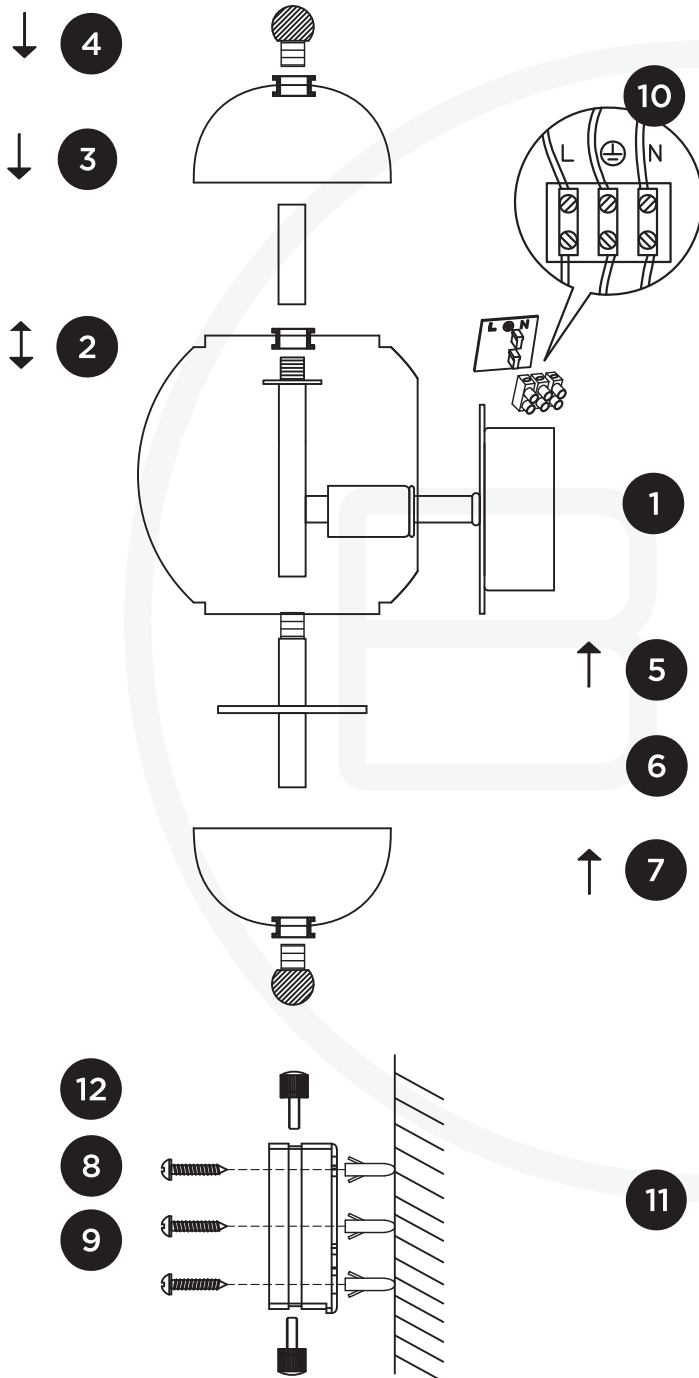

- 1 Place lightsource in the sockets
- 2 Place the metal ring onto the threading and bring T-shaped tube through the hole in the glass and attach the tube to the threading.
- 3 Carefully place the clear glass shade on top and make sure it is placed correctly.
- 4 Screw the metal knob onto the glass and press slightly while twisting and tightening.
- 5 Turn the lamp upside down and screw the metal rod with the frosted glass into the T-shaped tube.
- 6 Carefully place the second clear glass shade and make sure it is placed correct.
- 7 Screw the metal knob onto the glass and press slightly while twisting and tightening.
- 8 Always use the right plugs for your wall to mount the lamp securely.
- 9 Always make sure to use the correct screws to make sure the lamp is securely fastened.
- 10 If you hardwire your lamp, connect to the circuit.  
If you wish to use a cord, take out the metal plug that covers the bottom hole, bring the cord through the hole and connect the cord to the circuit.
- 11 Mount the lamp to the bracket with the three provided screws.
- 12