

Safety Instructions

1,2,3,4,5,6,7,8,12,14,16
19,20,24,28,33,34



Info

www.paulmann.com

Paulmann Licht GmbH
Quezinger Feld 2
31832 Springe
Germany

www.paulmann.com

Art.-Nr.: 79812
(+MA326) PYW 05/19

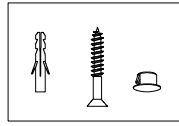
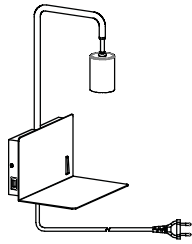

incl.

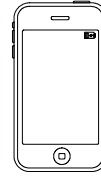
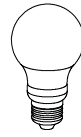

Not incl.

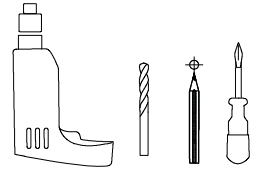
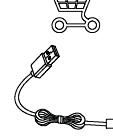

A

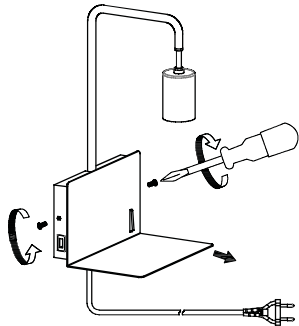

B1 B2

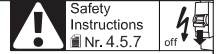
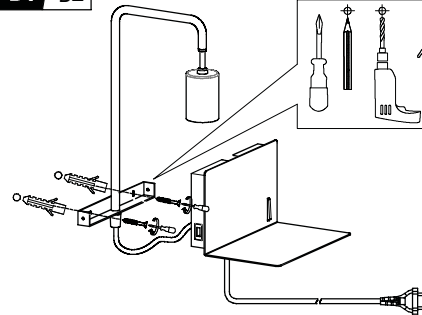

Safety Instructions
Nr. 4.5.7

B1 B2

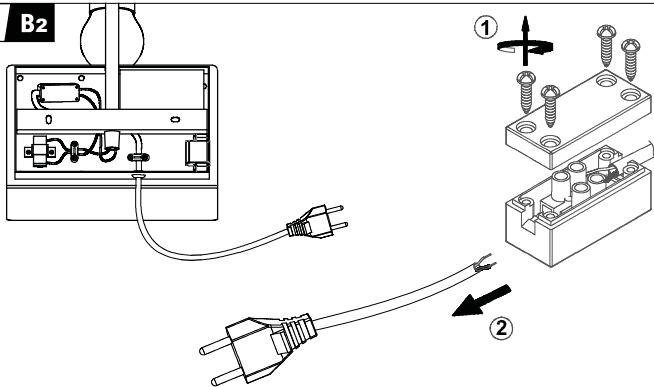

Safety Instructions
Nr. 4.5.7

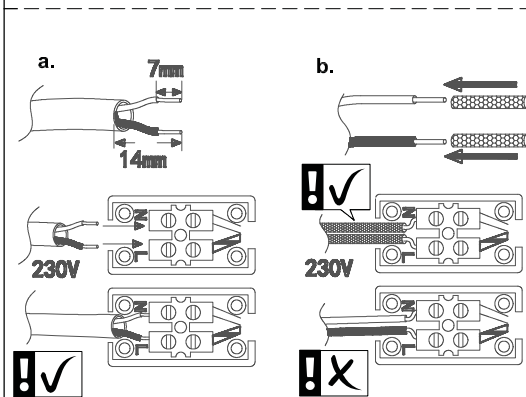
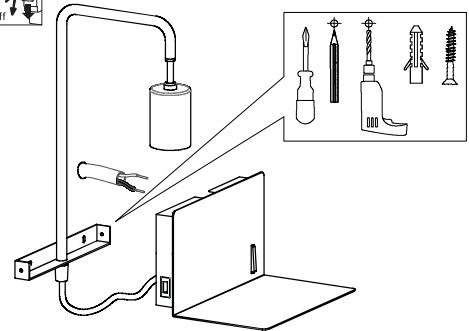

Safety Instructions
Nr. 3.4.5.6

1.

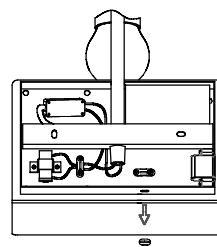

2.

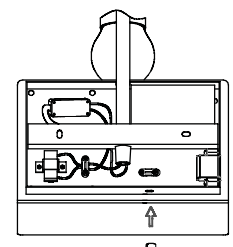

C

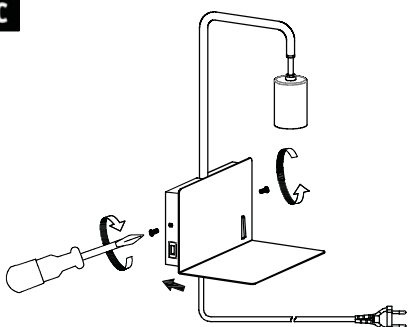

D

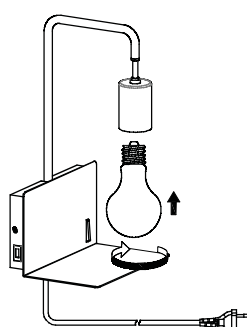

E

