

# Instruction manual

## Solar lighting items

### Function and intended use

The solar light items are suitable for outdoor use. The base material of the Items is synthetic resin. Either paint or ground sandstone is added to this material. This gives the product its special appearance. The lighting unit is installed inside of the product. The built-in battery is charged by the external solar module. The crystalline solar module can be plugged into the ground via a ground spike and is connected to the lighting unit with a cable. In sunshine it reliably charges the built-in battery. At night the light switches on automatically. The solar module must be installed in a sunny, shadow-free location. During the winter months, it is recommended to winter the solar flare in a warm, dry place. To do this, charge the battery on a sunny day and then switch off the solar light using the switch.

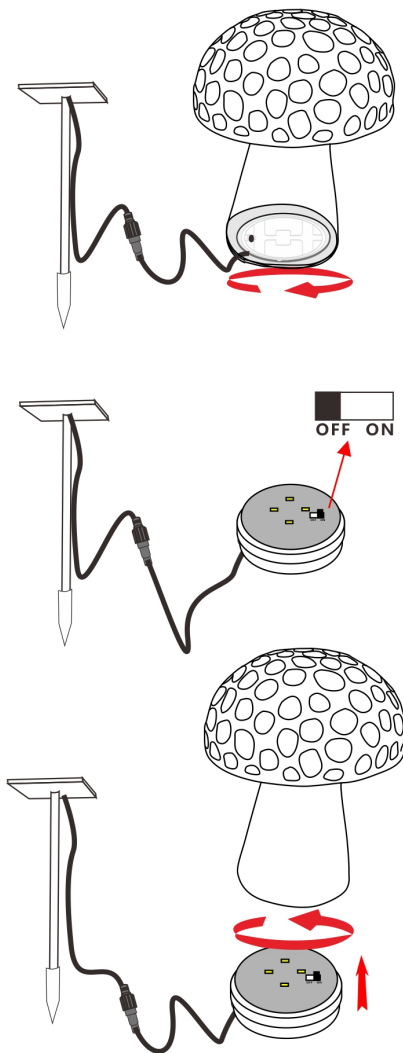

### Technical data

- Solar module: 0.24 Wp multicrystalline
- Light source:  
4 x warm white LEDs (2700 K)
- Light duration: approx. 4-6 hours with full battery
- Spare battery: Ni-Mh AA 1.2 V/ 800 mAh
- Protection class: IP 44
- Protection class: III

## Commissioning

1. Carefully remove the parts from the packaging.
2. Turn the lighting unit at the bottom of the ball counterclockwise completely out.
3. Slide the switch from off to on
4. Screw the lighting unit on the underside of the product firmly back in clockwise.
5. Remove the protective foil from the solar module and insert the solar module into the ground within reach of the cable with the enclosed ground stake.
6. Connect the plug connection of the solar module with that of the lighting unit and secure the plug connection with the screw cap.

The solar light is now ready for operation!

Note: The lighting duration is strongly dependent on the intensity and duration of the solar radiation during the day. In the spring and autumn months, less lighting duration is generally to be expected due to the low position of the sun. If the lamp does not light up on the first evening, please wait for a sunny day.

## Changing the battery

On average, the battery in the solar light must be replaced every 2-3 years by a new battery of the same type and design. A Ni-Mh battery AA 1.2 V/ 800 mAh is used here.

Please proceed as follows when replacing:

1. Unscrew the lighting unit on the underside of the ball completely counterclockwise.
2. Turn the switch to the „OFF“ position, loosen the two screws on the top of the cover and remove the cover.
3. Replace the battery with a new one of the same type.
4. Close the cover again and screw the two
5. screws back in firmly. Now select your light colour and screw the lighting unit back into the ball firmly in a clockwise direction.

## Disposal:

When you intend to dispose of the product in future, please consider that it contains valuable raw materials suited for recycling. Therefore, do not dispose it of with domestic waste but bring it to a collection point for the recycling of waste electrical and electronic equipment.

Thank you very much for your cooperation!



## Malfunctions

Lamp does not switch on at night!

Remedy: Is the solar module illuminated by extraneous light (e.g. spot lights)? Position the solar module in a darker place!

Remedy: Is the light switched on?

Remedy: Has the battery in the light reached the end of its service life? As a rule, the batteries must be replaced with identical types every 2 years!