



Safety Instructions



0,1,2,4,6,15,22
ta = 25C°



Info Hotline +49 (0) 5041 998 389

Mon. - Do. 7⁰⁰ - 20⁰⁰

Fr. 7⁰⁰ - 17⁰⁰



Paulmann Licht GmbH
Quezinger Feld 2
31832 Springe/Germany
www.paulmann.com

Art.-Nr.:

951.50

(+MA 173)

PH 04/13

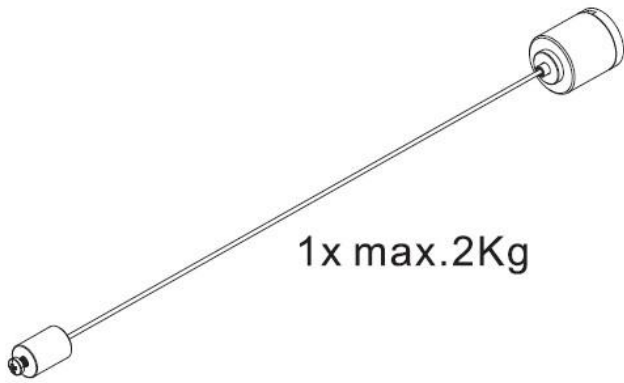

1x



1x

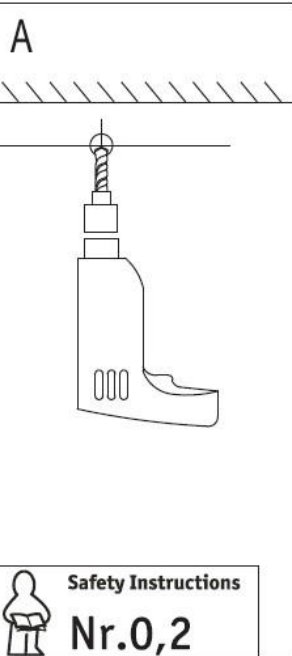
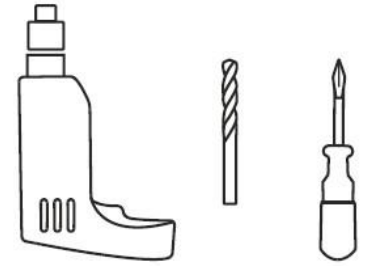

Safety Instructions
Nr.0,2

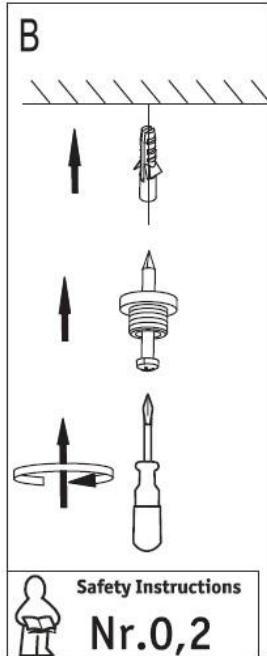

Safety Instructions
Nr.0,2

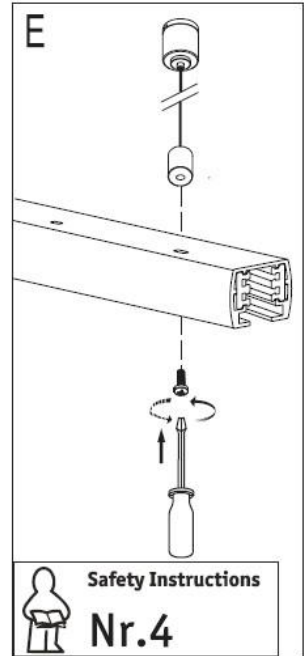
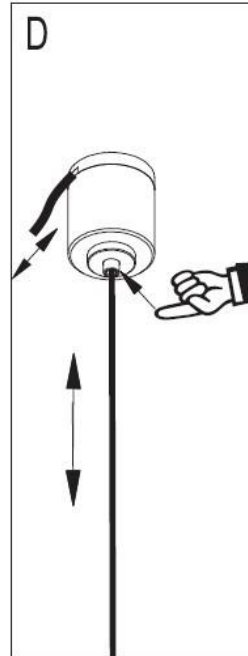
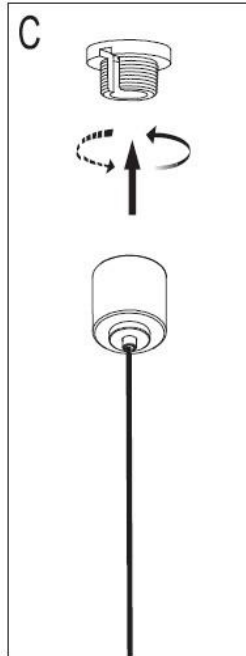

Safety Instructions
Nr.4

95137

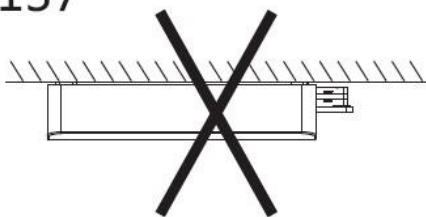

95135

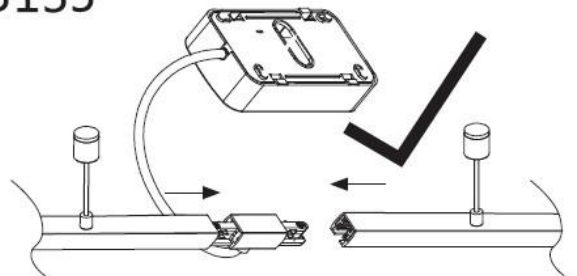

95139

