

Monteringsanvisning | Montageanleitung | Mounting instruction | Installationsanvisningar | Instructions de montage | Montage-instructies | Item N°: 2015700001  
Operating frequency range(s) : 2400 – 2483.5 MHz  
Maximum RF output power: <10dBm

### packing list

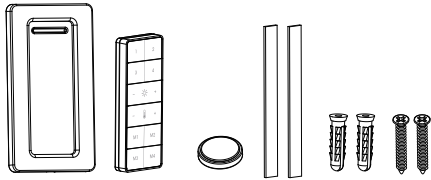

### Tools list

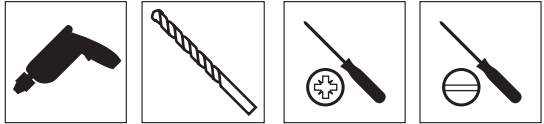

### a

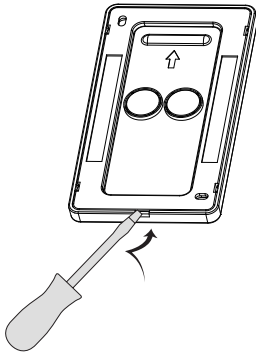

1

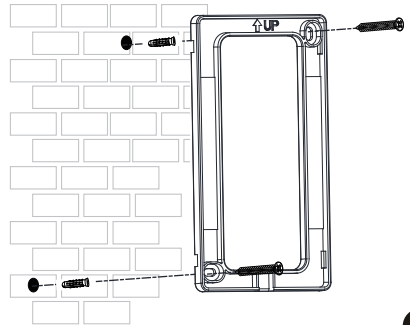

2

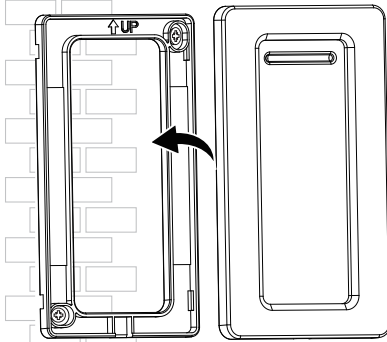

3

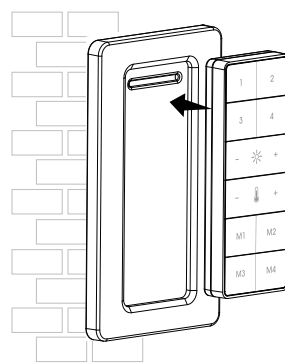

4

### b

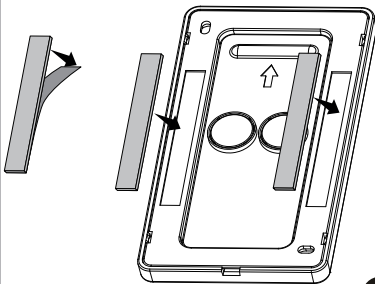

1

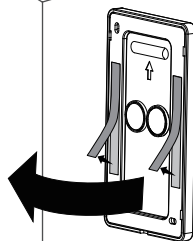

2

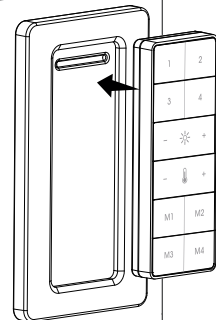

3

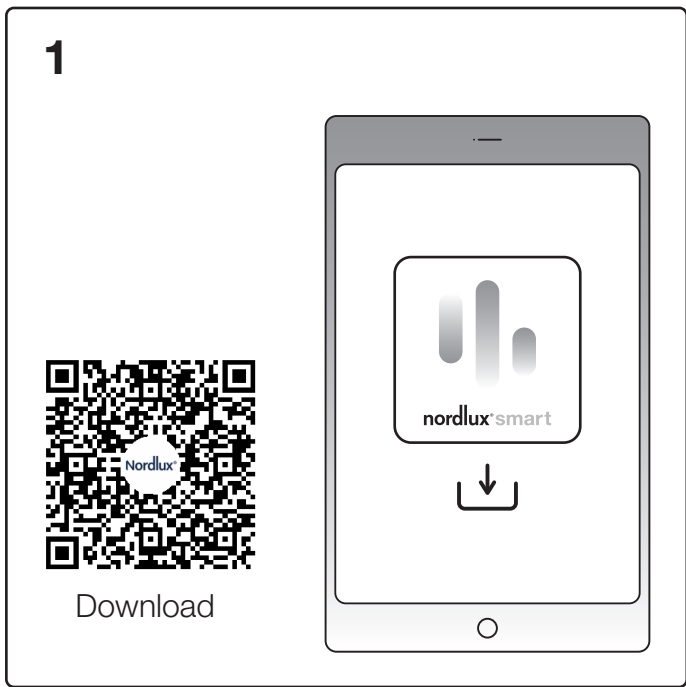

Download the Nordlux Smart app from the App Store or Google Play.

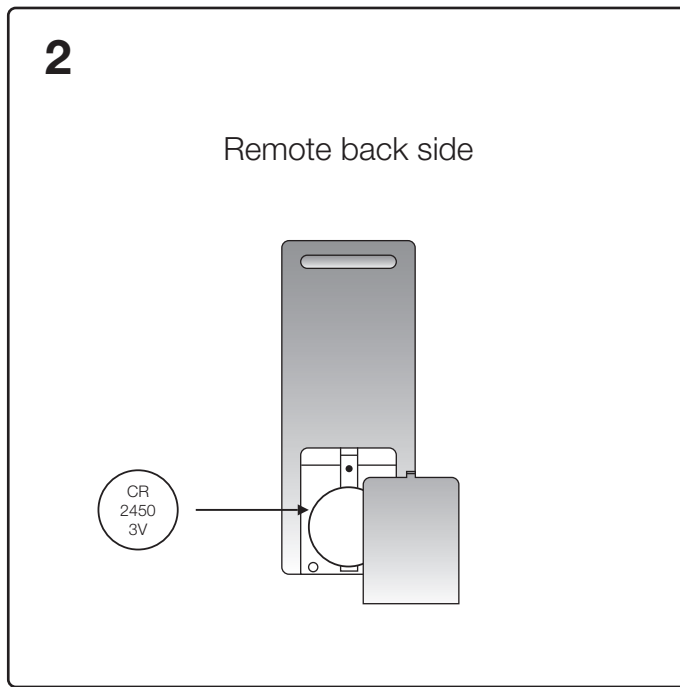

Remove the battery cap and insert 1 x CR 2450 3V battery.

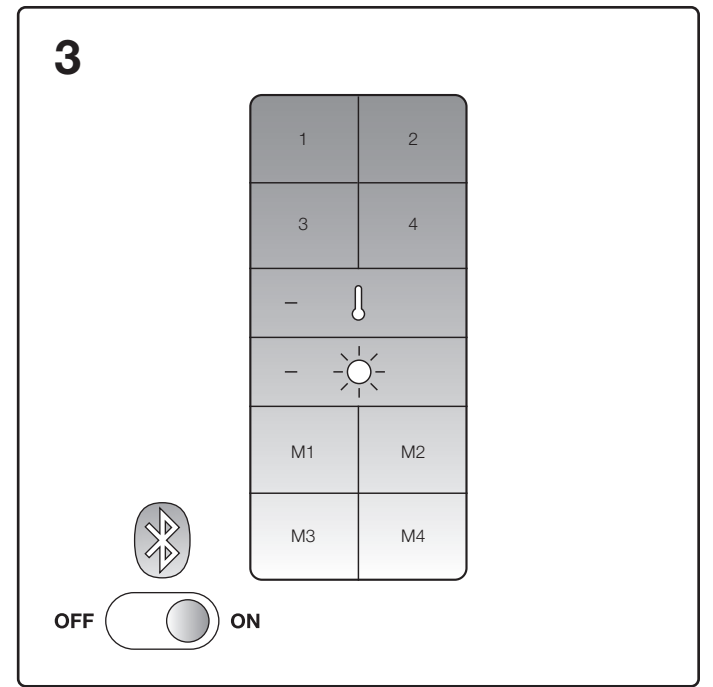

Turn on Bluetooth on your device. Distance to Remote Control is up to 5 meters.

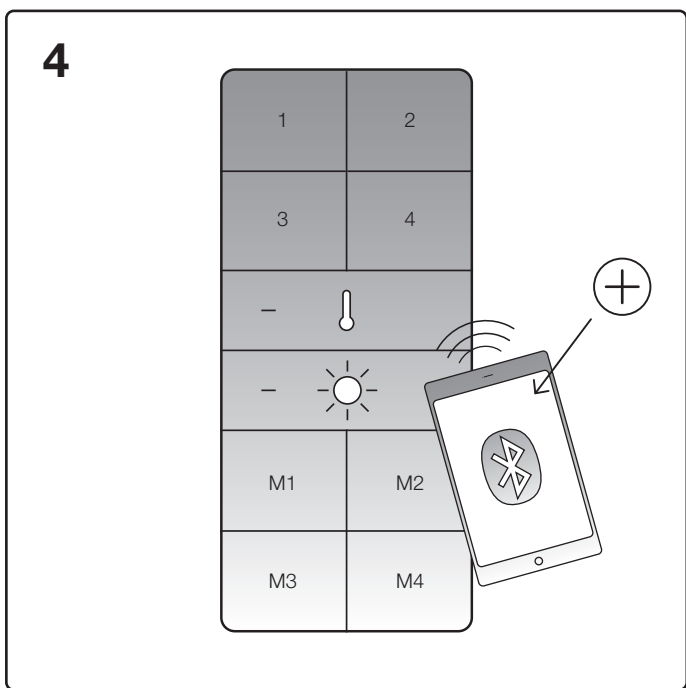

Open the Nordlux Smart app and tap the plus icon in the top right corner. Then tap the product category, where you should see your remote control pop up. Connect it.

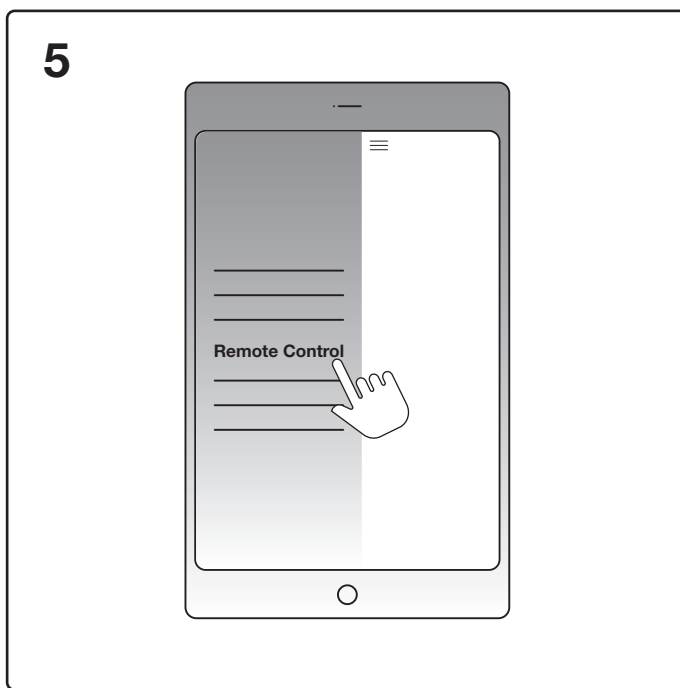

Expand the menu by clicking on the three horizontal lines in the left top corner. Find Remote Control on the list and click on it. Enter the Remote Control overview by clicking on the Nordlux Remote Control.

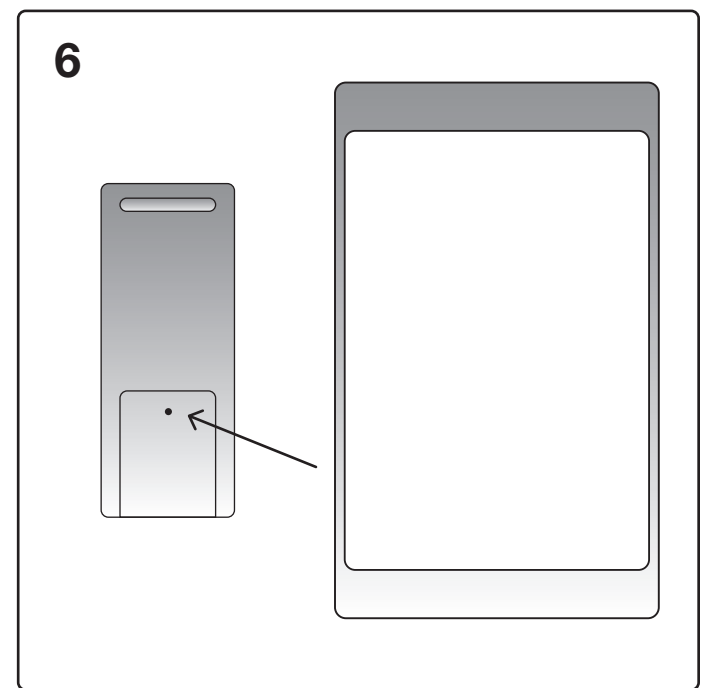

Click on "settings". To enter the settings you need to press and hold the setup button with a pointed object on the back of the Remote Control for 5 seconds. The '1' in the upper corner will start flashing blue.

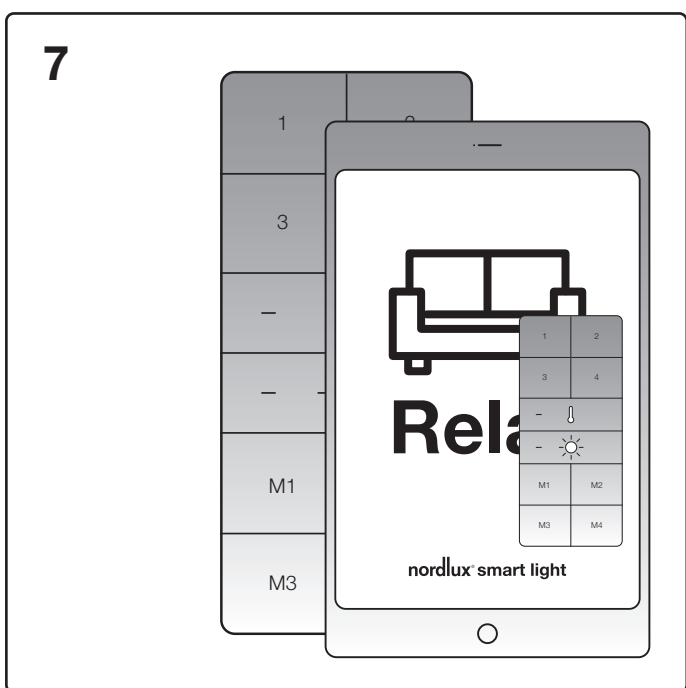

Link the buttons to moods and groups in the Nordlux Smart app.

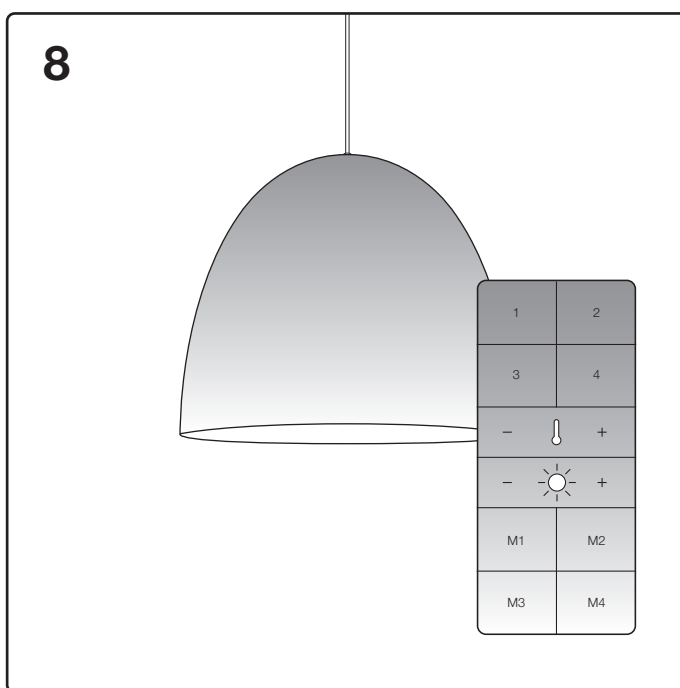

You can now control your Nordlux Smart products with the Smart Remote.



Waste electrical products should not be disposed of with household waste. Please recycle where facilities exist.  
Check with your Local Authority or local store for recycling advice.



Conformity with all relevant EC Directive requirements.



Do not ingest battery, Chemical Burn Hazard

This product contains a coin / button cell battery. If the coin / button cell battery is swallowed, it can cause severe internal burns in just 2 hours and can lead to death.

Keep new and used batteries away from children.

If the battery compartment does not close securely, stop using the product and keep it away from children.

If you think batteries might have been swallowed or placed inside any part of the body, seek immediate medical attention.

Replacement of a battery with an incorrect type that can defeat a safeguard;

Disposal of a battery into fire or a hot oven, or mechanically crushing or cutting of a battery, that can result in an explosion;

Leaving a battery in an extremely high temperature surrounding environment that can result in an explosion or the leakage of flammable liquid or gas;

And a battery subjected to extremely low air pressure that may result in an explosion or the leakage of flammable liquid or gas.

**START SMART**

**nordlux®**