

Art.-Nr.: 94278
PJY 11/19



1x



incl

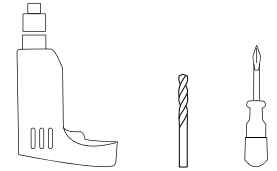

A

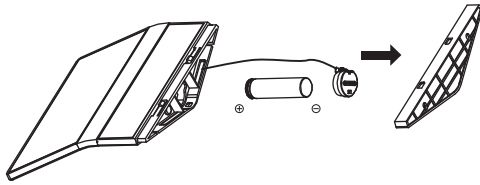

! only use rechargeable 1xLi-ion Batteries (DC3.7V, 1800mAh)

B

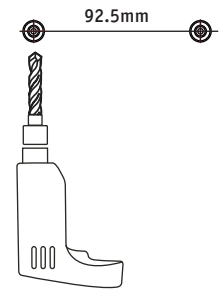

C

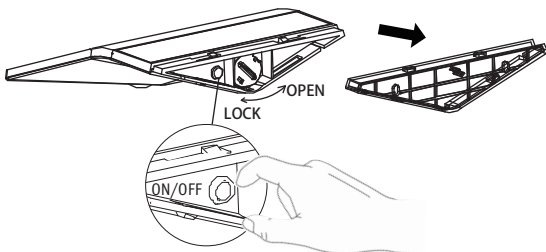

D

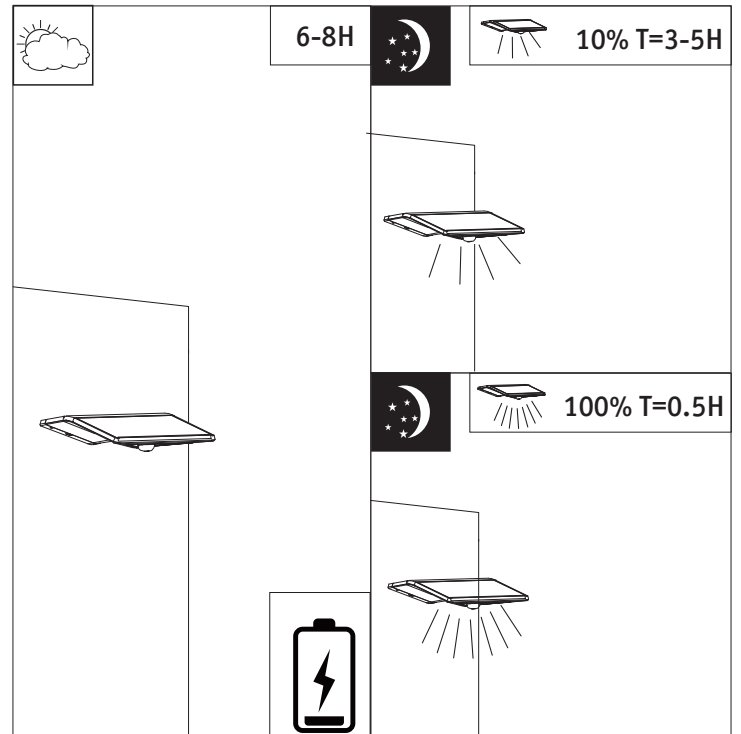
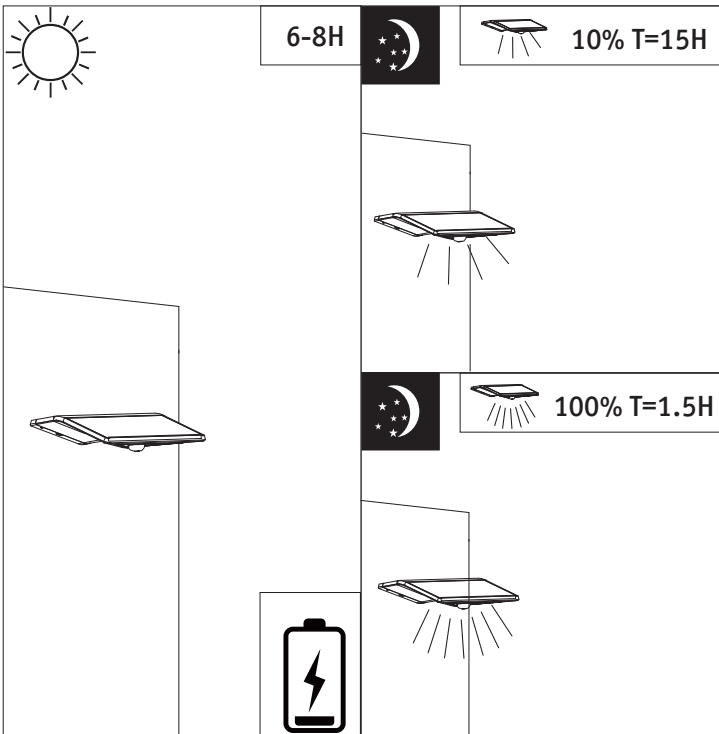
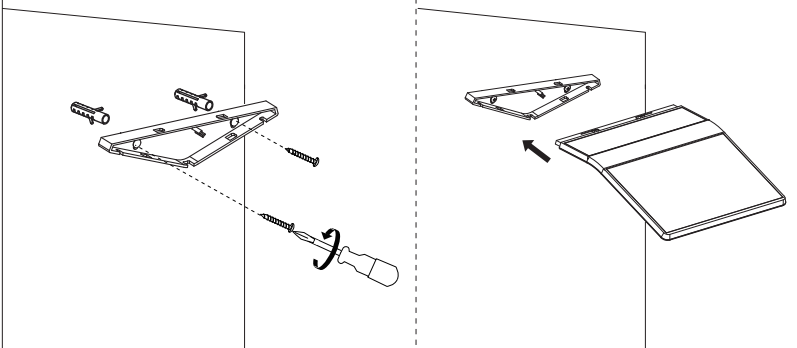

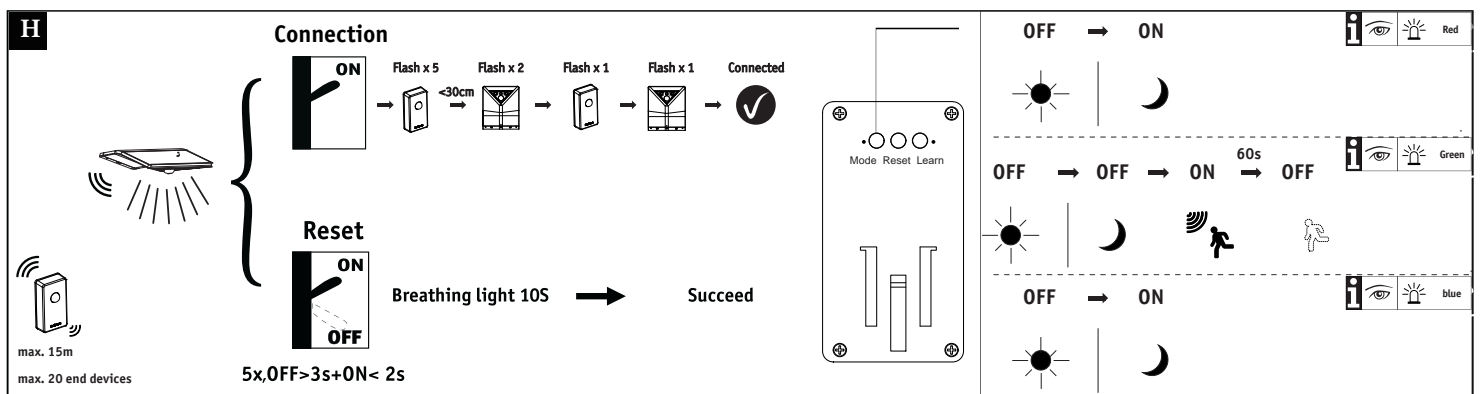
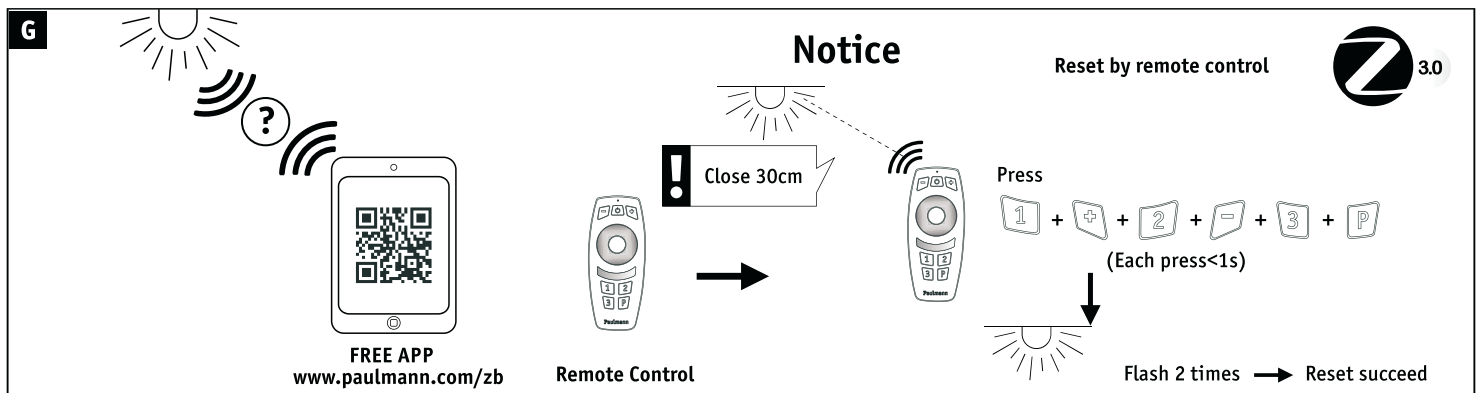
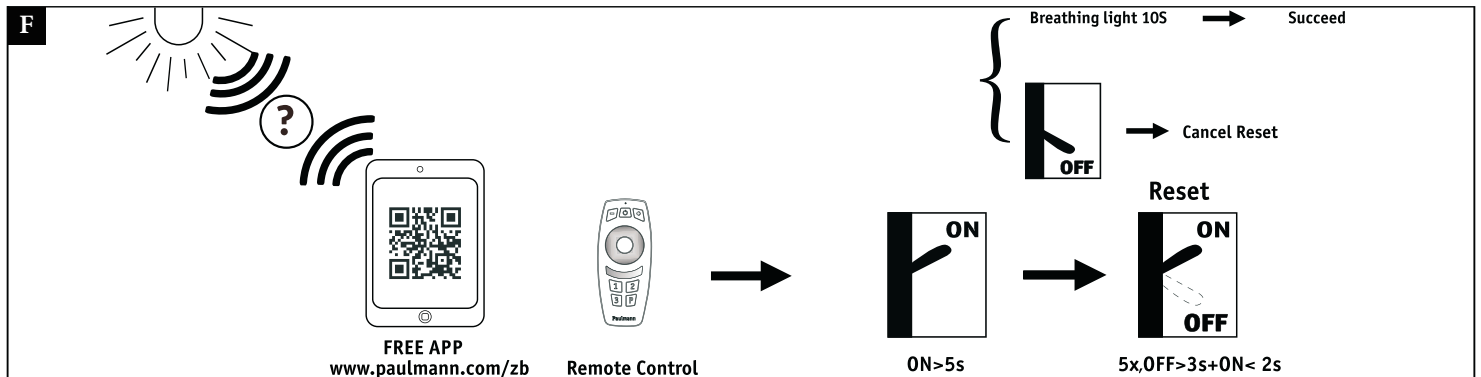
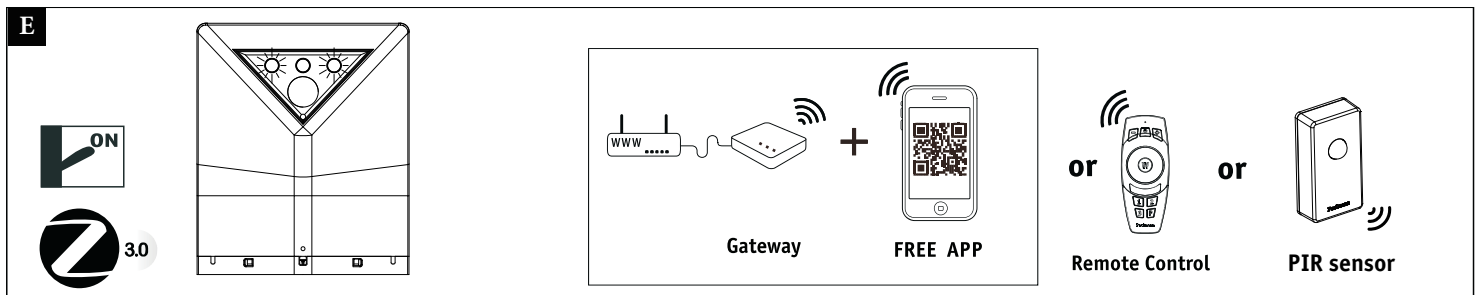

I

FREE App

Not incl. Smart Device
.ipad
.iphone 4s Higher
.Android 4.4 Higher

Not incl. Gateway

Not incl. Remote Control

Not incl. PIR sensor

Download App for extended functions
<https://www.paulmann.com/zb>

Paulmann Art.-Nr:500.66

Paulmann Art.-Nr.500.67

Paulmann Art.-Nr 180.12

Hiermit erklärt Paulmann Licht, dass der Funkanlagentyp Art.-Nr.: 94278 der Richtlinie 2014/53/EU entspricht. Der vollständige

Text der EU-Konformitätserklärung ist unter der folgenden Internetadresse verfügbar: www.paulmann.de

Zugelassen für den Betrieb in allen Ländern der EU / Approved for operating in all European countries

CE: Konform mit / in accordance with / conformément a 2014/30/EU, 2014/53/EU <http://www.paulmann.com/de/de/b2b-haendler-log-in.html>

Funk-Frequenz :2.4GHz -2.4835GHz Abgestrahlte Energie :10mW NO

Doesn't apply for the geographical area within a radius of 20km from the centre on "Ny Alesund"