

# PC TABLE LAMP

PRODUCT FACT SHEET



**HAY**

## PC TABLE LAMP

DESIGN BY PIERRE CHARPIN, 2019

Pierre Charpin's PC Table Lamps is a collection of refined freestanding tabletop lamps. The lamps are constructed in anodised aluminium, which makes the surface more resistant to corrosion. The light source is hidden from view by a removable polycarbonate moulded diffuser, creating both a soft directional downlight effect and determining the form of the lamp itself. The PC Table Lamps are available in a variety of sizes and colours, and are suitable for both contract and domestic markets.

### HIGHLIGHTS

- Part of a progressive and technologically advanced lighting collection.
- A family of refined pendants, task lights, table and portable lamps.
- CE approved.
- Designed for use with a replaceable standard retro fit LED dimmable bulb.
- Touch step dimmer.
- Table lamp suitable for both private and office environments.
- Qualified for contract use.

### DIMENSIONS

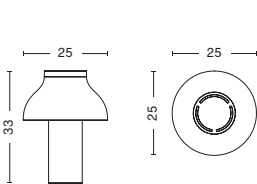

#### SMALL

WIDTH 25 CM | 9.8"  
DEPTH 25 CM | 9.8"  
HEIGHT 33 CM | 13"

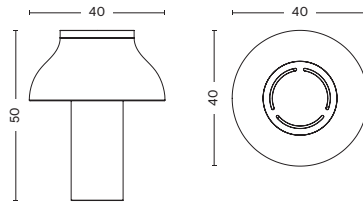

#### LARGE

WIDTH 40 CM | 15.7"  
DEPTH 40 CM | 15.7"  
HEIGHT 50 CM | 19.7"

### MATERIALS

#### SHADE

Anodised spun aluminium shade.

#### BASE

Anodised extruded aluminium base with a cast iron internal weight.

#### DIFFUSER

Injection moulded translucent polycarbonate diffuser.

#### CABLE

Braided textile cable with PVC insulation. Please note that the cable is black for all colour options.

### COLOUR & FINISH

Please note that the colour codes are indicative.



SOFT BLACK  
RAL 9004



ALUMINIUM  
ANODISED

## PC TABLE LAMP SMALL

### TECHNICAL SPECIFICATIONS

RECOMMENDED LIGHT SOURCE*	DIMMABLE	POWER SUPPLY	IP	CORD LENGTH	SWITCH
LED E27 (A19), 10-13W (max. 13W), 1000-1500lm, 2700-3000K warm white	Yes	220-240V AC at 50/60Hz EU plug mounted (UK adaptor included)	20	200 cm	Touch step dimmer (Integrated in the entire base)

\*Bulb not included. Globe style bulb is not recommended.

### TEST SPECIFICATION OUTPUTS\*

FLUX (LUMENS)	CCT (KELVIN)	CRI (1-100)
360lm	2700K warm white	80

\*Photometrics and the test specification shown is taken using the recommended LED bulb fitted in the production luminaire.

### PHOTOMETRICS

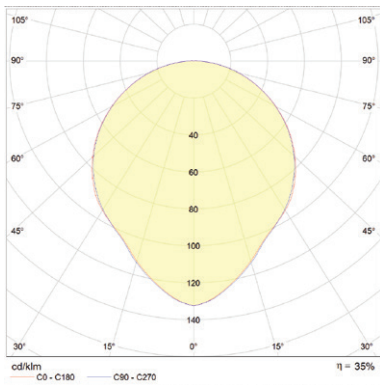

### CERTIFICATES

CE APPROVED

This product has been assessed and complies with the essential requirements of the relevant European directives.



Tested according to the following European EN IEC standards which relate specifically to electrical lighting products including:

- EN 55015:2013 (radio disturbance)
- EN 61547:2009 (EMC immunity)
- EN 61000-3-2:2014 (EMC compatibility)
- EN 61000-3-3:2013 (EMC compatibility)
- EN 60598-2-4:1997 (portable luminaires)
- EN 60598-1:2015 (general requirements)
- EN 62493:2010 (human exposure to EMC)

### COUNTRY OF ORIGIN

China

### DOWNLOADS

Packshots and lifestyle photos, 2D / 3D files, care and maintenance, instructions, test certificates, product fact sheets, and product presentations are available in our Image Bank at hay.com.

[LINK TO IMAGE BANK](#)

## PC TABLE LAMP LARGE

### TECHNICAL SPECIFICATIONS

RECOMMENDED LIGHT SOURCE*	DIMMABLE	POWER SUPPLY	IP	CORD LENGTH	SWITCH
LED E27 (A19), 10-13W (max. 13W), 1000-1500lm, 2700-3000K warm white	Yes	220-240V AC at 50/60Hz EU plug mounted (UK adaptor included)	20	200 cm	Touch step dimmer (Integrated in the entire base)

\*Bulb not included. Globe style bulb is not recommended.

### TEST SPECIFICATION OUTPUTS\*

FLUX (LUMENS)	CCT (KELVIN)	CRI (1-100)
550lm	2700K warm white	80

\*Photometrics and the test specification shown is taken using the recommended LED bulb fitted in the production luminaire.

### PHOTOMETRICS

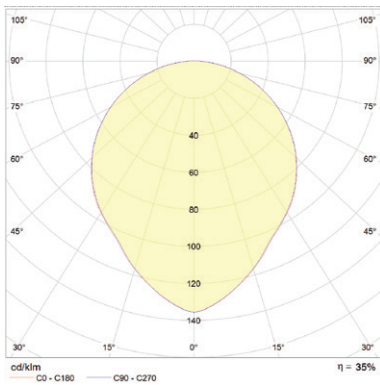

### CERTIFICATES

CE APPROVED

This product has been assessed and complies with the essential requirements of the relevant European directives.



Tested according to the following European EN IEC standards which relate specifically to electrical lighting products including:

- EN 55015:2013 (radio disturbance)
- EN 61547:2009 (EMC immunity)
- EN 61000-3-2:2014 (EMC compatibility)
- EN 61000-3-3:2013 (EMC compatibility)
- EN 60598-2-4:1997 (portable luminaires)
- EN 60598-1:2015 (general requirements)
- EN 62493:2010 (human exposure to EMC)

### COUNTRY OF ORIGIN

China

### DOWNLOADS

Packshots and lifestyle photos, 2D / 3D files, care and maintenance, instructions, test certificates, product fact sheets, and product presentations are available in our Image Bank at hay.com.

[LINK TO IMAGE BANK](#)