

INSTRUCTION MANUAL

Model: Classic fatningsæt

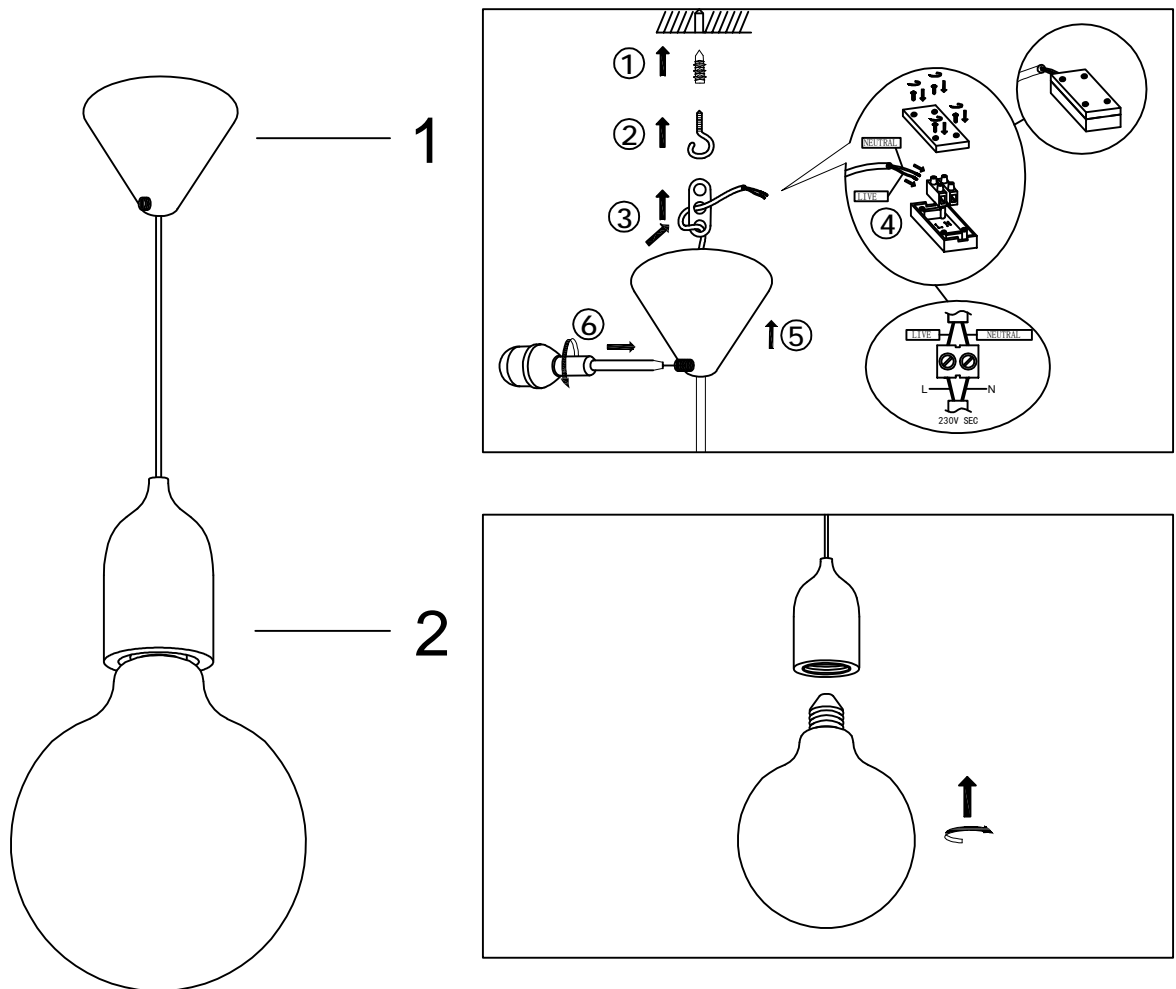

INSTRUCTION MANUAL

- Follow the instruction sketch.
- Make sure power is OFF on the outlet, before beginning the installation.
- Insert the light bulb.
- Go through point 1 to 2 before connecting the lamp to the power.

230V.E27 MAX 40W G125 or MAX 25W

