

Kare Pendant Lamp

Assembly manual

fermliving.com

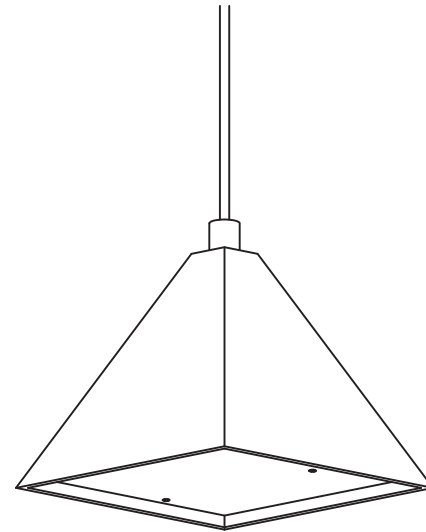

ferm
L I V I N G

General Instructions

PLEASE READ BEFORE INSTALLATION

WARNING:

The safety of this fitting can only be guaranteed if the following instructions are observed during both installation and use. Please retain these instructions safely after installation.

PLEASE OBSERVE THE FOLLOWING GUIDELINES:

- Ensure that the power supply has been switched off prior to installation or removal of the product.
- Never undertake an electrical installation without the proper knowledge or training. If not familiar with electrical wiring, contact a qualified electrician.
- The product may in no way be modified or tampered with. Any modification may compromise safety and make the product itself dangerous to use. FERM LIVING does not accept any responsibility for products that have been modified.
- Any modification must be performed only by qualified personnel to avoid any danger.
- This product is meant for indoor use only.
- This appliance should not be disposed in a domestic trash receptacle and should instead be recycled appropriately.

CLEANING INSTRUCTIONS:

- Use only a soft cloth to clean the product. Dampen the cloth with water and soap or a mild cleanser if needed.

MORE INFORMATION:

To access further information such as product overview and material descriptions, please visit our website at www.fermliving.com. If you have any questions or comments, please do not hesitate to contact us at info@fermliving.com.

Technical Specifications

KARE PENDANT LAMP

Voltage:	220-240V – 50Hz
Dimmable:	No
Certification:	CE, UKCA, IP20, Class II
Socket:	G9 socket base
Recommended light source:	Bulb max 3w LED

Box Content

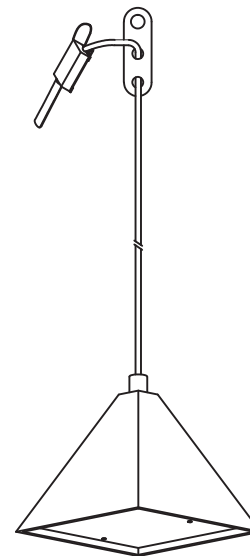

1 x Lamp



1 x Hook



1 x Rawplugs

Needed tools

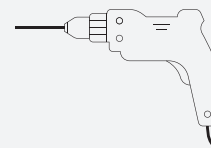

Electrical drill



Slotted Screwdriver

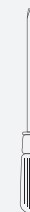

Screwdriver Cross

Assembly Process

1

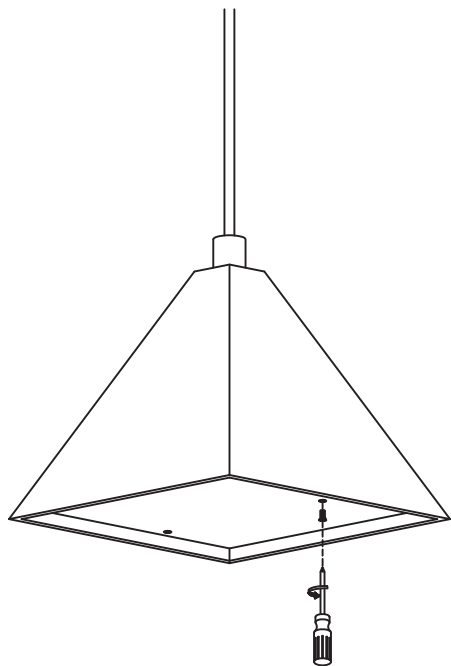

Unscrew the 2 screws
and remove the acrylic diffuser

4

Assembly Process

2

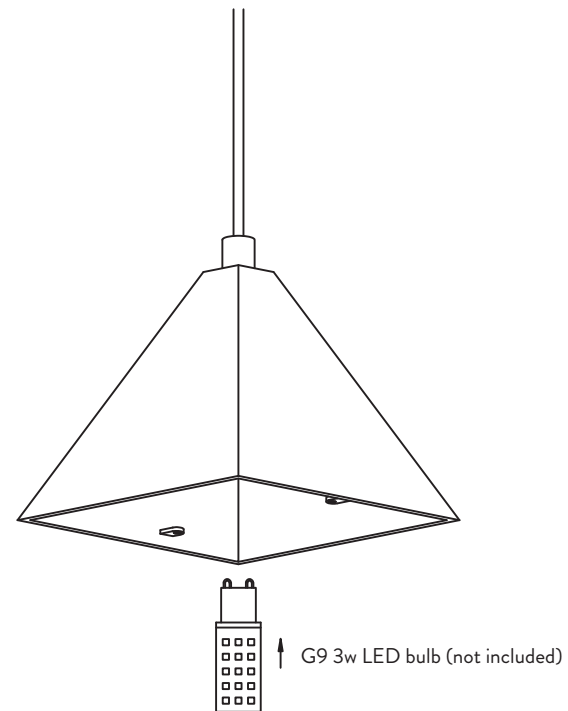

Fix G9 3w LED bulb into the socket

5

Assembly Process

3

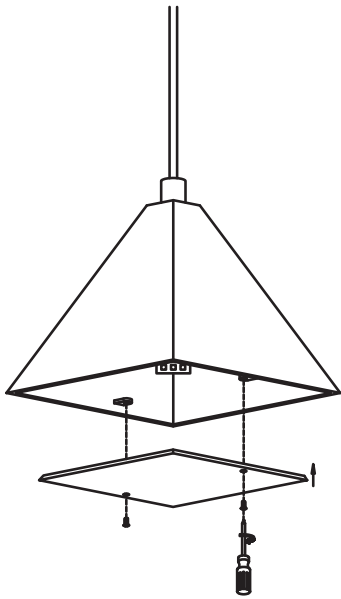

Attach the acrylic diffuser to the two holders and tighten it with two screws.

6

Assembly Process

4

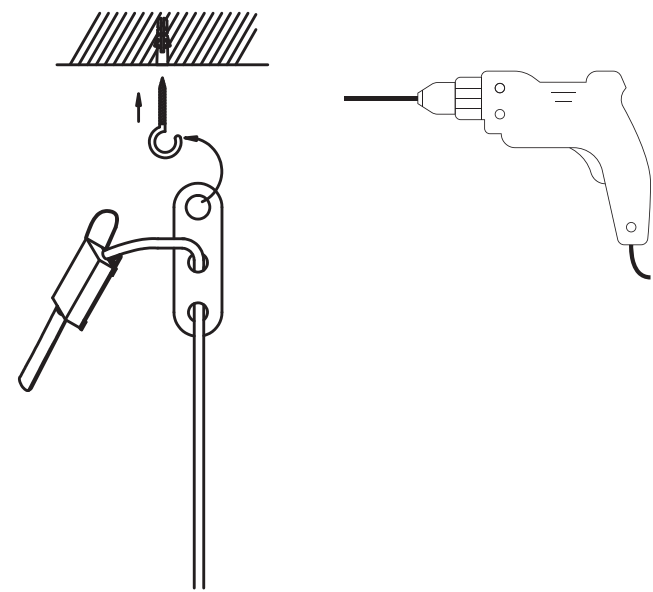

Drill one hole in the ceiling with a $\varnothing 5$ drill, set up the rawplug into the hole, then screw the hook and attach the lamp onto the hook.

7