

Safety Instructions

1, 2, 3, 4, 5, 6, 7, 8, 9, 12, 13
15, 16, 17, 18, 19, 20, 21, 22,
24, 25, 26, 27, 28, 33, 34



Info Hotline

+49 (0) 5041 998 389



Mon.-Do. 7⁰⁰-20⁰⁰
Fr. 7⁰⁰-17⁰⁰

Paulmann Licht GmbH
Quezinger Feld 2
31832 Springe
Germany

www.paulmann.com

Art.-Nr.:
935.66
935.67

(+MA 0326)PKE 08/16

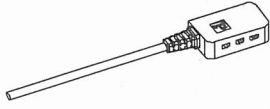

1x

935.66



3x

935.67



3x

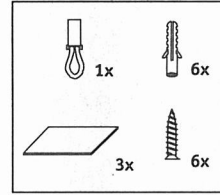

incl

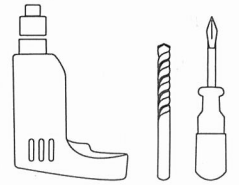

A1 A2

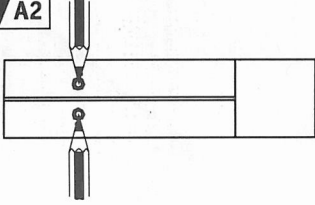

1-1.

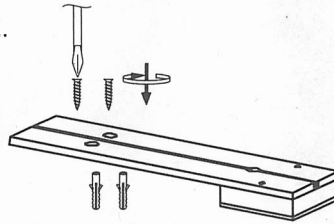

1-2.

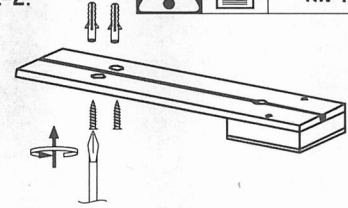

Safety Instructions
Nr. 4, 5, 7

A1 A2

2-1.

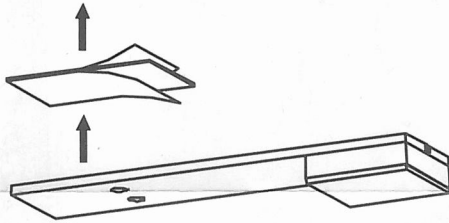

2-2.

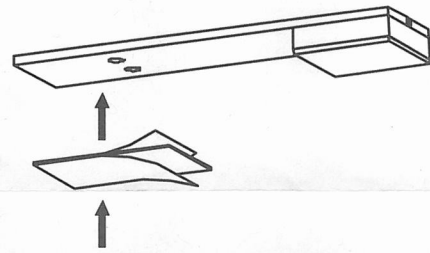

B



Safety Instructions
Nr. 19,20

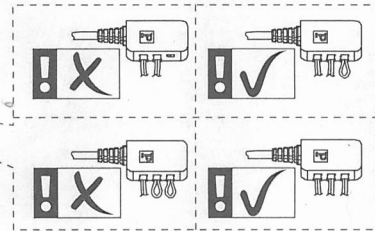
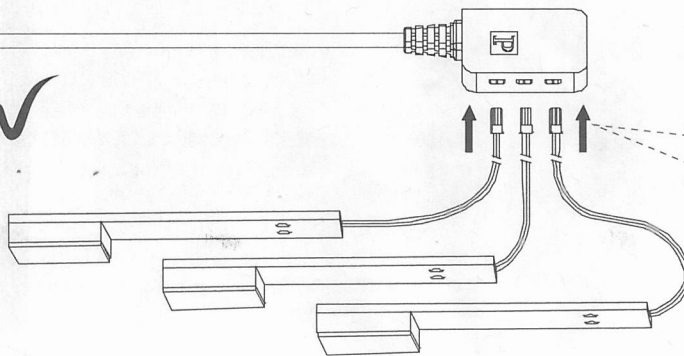
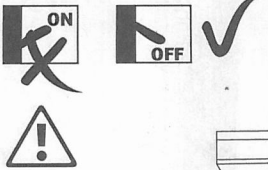

C

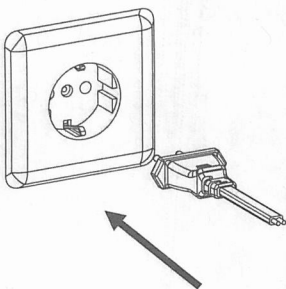

A1,B,C

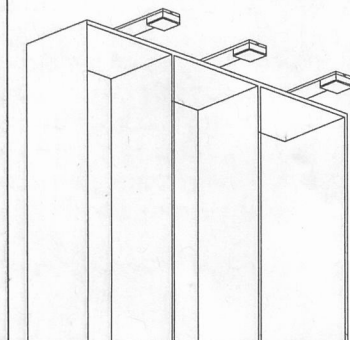

A2,B,C

