

Designed by Robert Dudley Best

PRODUCT



COLOURS



// Black / Chrome



// Off-White / Chrome



// White / Chrome

DESCRIPTION

Bestlite has been in continuous production since 1930. Robert Dudley Best created Bestlite design. He was highly influenced by the Bauhaus. In the past 80 years, people appreciated the lamps and it decorates many homes, hotels and restaurants worldwide. Loved by architects, designers and design aficionados throughout its 80-year history, today, Bestlite enjoys global iconic status.

VERSION - BESTLITE WALL LAMP BL7

Shade and base: Black, White or Off-White
Arm: Chrome

Colour codes are indicative.

- Fabric wire - Black:
- Black / White inside // RAL 9005 / RAL 9003 // Gloss level 20 / Gloss level 20

- Fabric wire - Off-White:
- Off-White / White inside // RAL 1015 / RAL 9003 // Gloss level 20 / Gloss level 20

- Fabric wire - White:
- White / White inside // RAL 9003 / RAL 9003 // Gloss level 20 / Gloss level 20

Please contact us for other colours or finishes.

VERSION

Order item - look for part number in the pricelist.

Series contains the following:

BL5, BL6, BL7, BL10

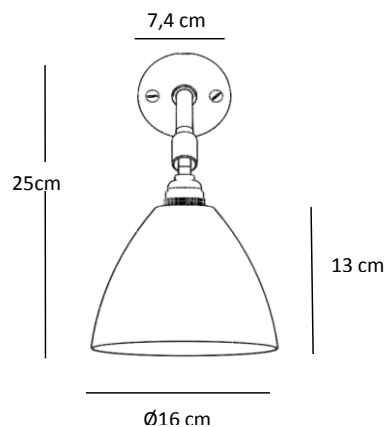

FACTS

MEASUREMENT - L X W X H MM

Lamp height: 290 mm
Tube length: - mm
Shade height: 140 mm
Shade diameter: Ø160 mm
Cord - total length w/sw: App. 2400 mm
Cord - exposed out of lamp: App. 2000 mm

WEIGHT ITEM - LAMP INCL. WIRE

489 g

PACKAGING TYPE

White cardboard box w/ 5ply corrugated

PACKAGING MEASUREMENT - L X W X H CM

L:26 x W:28 x H:20 cm

WEIGHT PACKAGING - MATERIAL TYPE

- Paper Egg crate: 280,5 g
- PE polybag: 60 g
- Cardboard inside: 26 g
- Cardboard outside: 206 g

WEIGHT PACKAGING - TOTAL

1001 g

NUMBER OF PARCELS

1 pcs.

LIGHT SOURCE

- Socket: E14 base
- Recommended light source: *All fluorescens light bulbs*
- Recommended wattage: 9 W = (40 WATT incandescent bulbs)
- Max wattage: 13 W

- Recommended light source: *Halogen light bulb*
- Recommended wattage: 28 W = (40 WATT incandescent bulbs)
- Max wattage: 30 W

- All lamps can be fitted with a dimmer.
Please contact your local electrician.

- Lightbulb not included

Designed by Robert Dudley Best

CLEANING AND MAINTENANCE

Use a soft damp cloth when cleaning your Bestlite lamp. Do not use household cleaners.

ACCESSORIES

-

ENVIRONMENT

-

TESTS

-

CERTIFICATION AND LABELS

CE-CERTIFIED

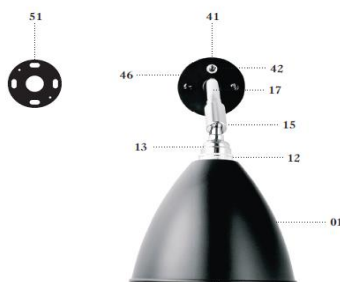

ON DEMAND - (ordered at an additional charge)

ORDERING - BL7 Hard-wired (switched):
No cord, switch on the wallbracket

- Euro voltage: 230 V
- Frequency: 50 Hz
- Supply voltage: AC power ~
- Normally Closed: IP20



Class II / Double insulated



CE-Mark



Luminaires accepted for mounting on a flammable base

KOMPONENTS

Item no.: 001-0729X

- 01 // Shade Ø16 cm.
- 05 // E14 lamp holder
- 10 // Insulating ring
- 11 // Internal shade ring
- 12 // External shade ring
- 13 // Lamp holder cover
- 15 // Universal joint
- 17 // Bestlite arm

- 41 // Push button switch
- 42 // Cover for push button switch
- 46 // Wall bracket
- 49 // Screw 9x19 mm.
- 51 // Mounting plate Ø7 cm

MATERIAL

Shade and base: Powder coated aluminium
Tube and arm: Chromed steel

INSTALLATION INSTRUCTIONS

The Bestlite key:

It's a practical tool that enables you to fasten the lamp arm. Simply use it like a screwdriver in the slot in the Bestlite nut.

1:1 template for pre-drilling

Cut out an exact 1:1 photocopy, and use directly on your wall for accurate placement of the holes.

Make sure the horizontal line is level.

Technical information:

Light source: E14, 1x40W incandescent or 1x30W halogen bulb.
Turn power off when changing light bulb.
The lamp is not approved for outdoor use or use in damp/bath rooms.

Some advice on cleaning your Bestlite:

Powder coated parts – base/bracket and shade:
Wipe the parts with a damp cloth soaked in warm water and a bit of mild detergent.

Chrome plated parts:
Wipe the parts with a damp cloth and wipe dry to bring up shine.
If the surface is shiny use a metal polish made especially for chromium or other soft metals.
Use only soft cloth for wiping and polishing, never sponges or steel wool.
Do not use abrasive or alkaline cleaning materials, glass cleaners or household ammonia.
Do not use acids or alkaline cleaning materials, glass cleaners or household ammonia.

BESTLITE • GUBI • Kjobenhavnvej 7 • DK-2180, Nordhavn, Denmark • www.gubi.com

Dear Bestlite customer,
Congratulations on your Bestlite!
You have chosen a genuine design classic, which has been in continuous production for more than 75 years.
On the other side of this leaflet you will find some useful instructions for the use of your Bestlite.
Should you have any questions, please feel free to e-mail us at info@gubi.com or visit us at www.gubi.com.

Best regards,
Bestlite

BESTLITE
BY GUBI

The Bestlite clip
The BL 1, BL 2, BL 3, BL 4, BL 5, BL 6, and BL 10

A practical tool that enables you to fasten the lamp arm - simply use like a screwdriver in the slot in the Bestlite nut.

Wall mounting instructions
The BL 1, BL 2, BL 3, BL 4, BL 5, BL 6, BL 7, and BL 10

The wall mounting plate

Four holes, mount the plate to the wall through these - use appropriate screws and plugs.

Two threaded holes, mount the cap through these. Use the supplied Bestlite screws in these holes (see below).

Position of these two holes should always be horizontal.

Mounting the plate as shown is important since the lamp is only straight if the plate is straight.

Wall mounting:

- Choose and pencil mark the wall carefully. Pre-drilling and use of plugs in the wall is recommended.
- Mount the plate - make sure you use appropriate screws and plugs for your wall as the plate carries the weight of the lamp.
- When mounting the BL 5, mount the lamp with the upper cap attached to top of the plate. Use about 1 cm and only mount the upper cap when the lamp is secured in its straight position.
- When the plate is fastened to the wall - adjust the lamp by covering the clip and lamp into into the plate.