

V4456. 20  
V4456. 01

1

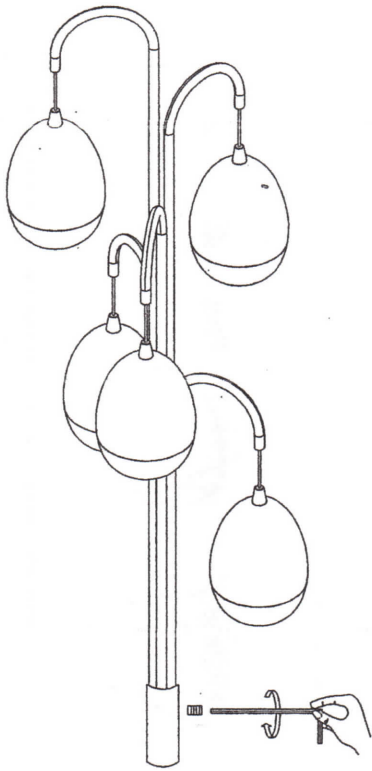

3

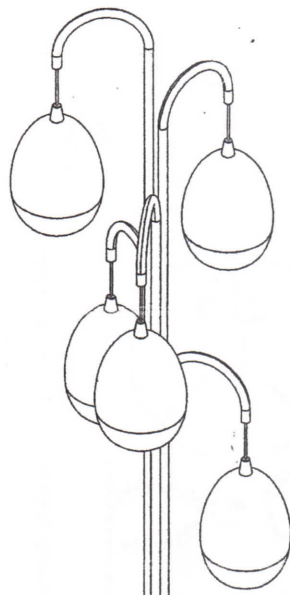

2

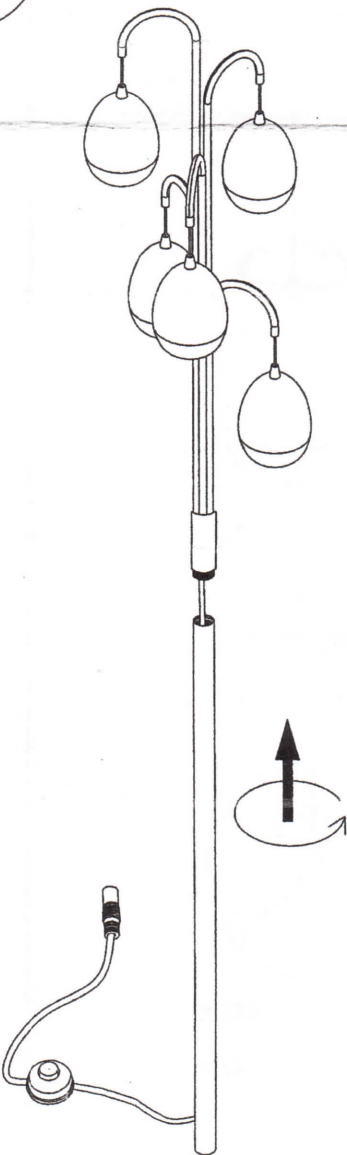

Press the switch to  
change brightness

1. This light fitting operates at a normal supply voltage of 220-240V.
2. When changing the bulb or fuses, always switch off at the mains and allow the old bulb to cool down before handling.
3. If the external flexible cable of the lamp is damaged, it shall be exclusively replaced by the manufacturer or his service agent or a similar qualified person in order to avoid a hazard.

# How to clean the inside of glass

## Step A: Disassemble the head

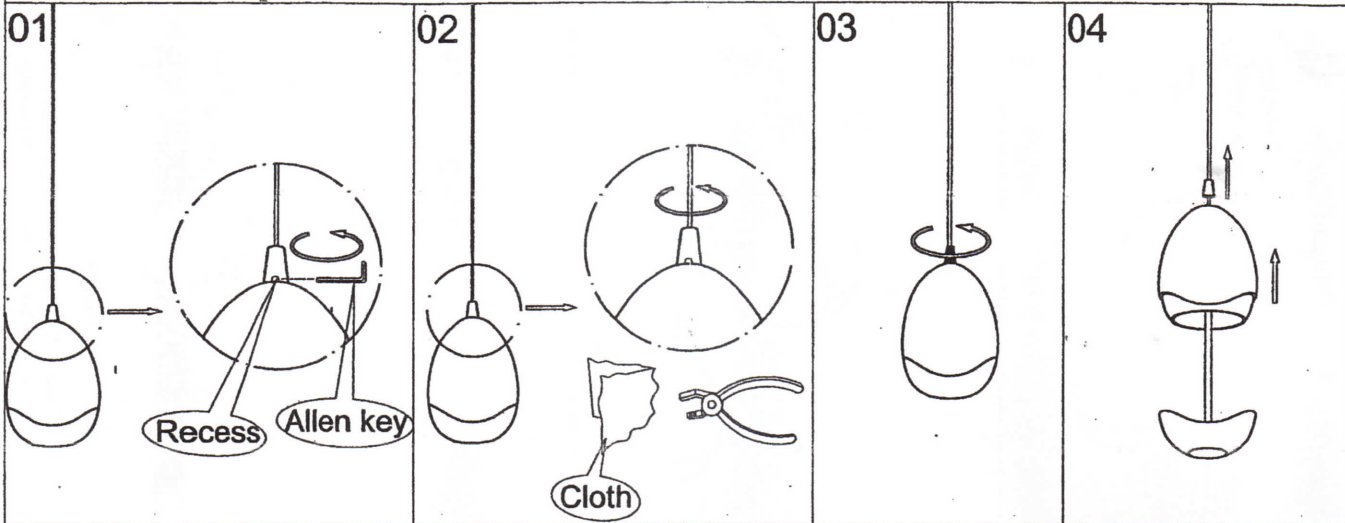

## Step B: Wipe the inner surface of glass with soft clean dry cloth gently

## Step C: Reassemble the head

