

- INSTRUCTION MANUAL -

MARSELIS COLLECTION

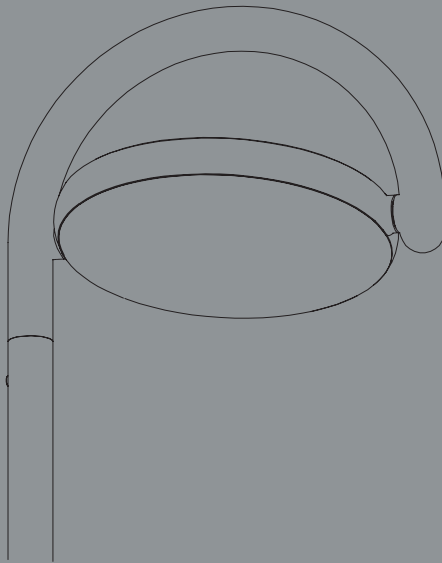

DESIGN BY KASCHKASCH

HAY

- GENERAL INFORMATION -

TECHNICAL DATA

This product is supplied with an integrated LED light source. The expected lifespan of the LED light source is 25,000 hours, which equates to 8-10 years of general use. When the light source reaches its end of life, the whole luminaire should be replaced.

FITTING TYPE | Integrated LED

POWER (W) | 4W

COLOUR TEMPERATURE | 3000K warm white.

ATTENTION

Ensure that the power supply to the circuit has clearly been turned OFF before installing the product. In some countries, electrical installation must be carried out by authorised electricians/contractors; please check with your local authority for guidance.

The product must not be modified in any way. HAY accepts no responsibility for any products that have been modified or tampered with. The external flexible cable or cord of this luminaire cannot be replaced. If the cord is damaged, the luminaire should be replaced. This lamp is designed for indoor use only.

CARE AND MAINTENANCE

The product can be cleaned with a soft damp cloth and mild detergent, or a dry microfibre cloth. Do not use alcohol or any other solvents to clean the product and avoid using abrasive or rough sponges. Ensure that the power supply has been turned OFF before cleaning the product.



- PARTS -

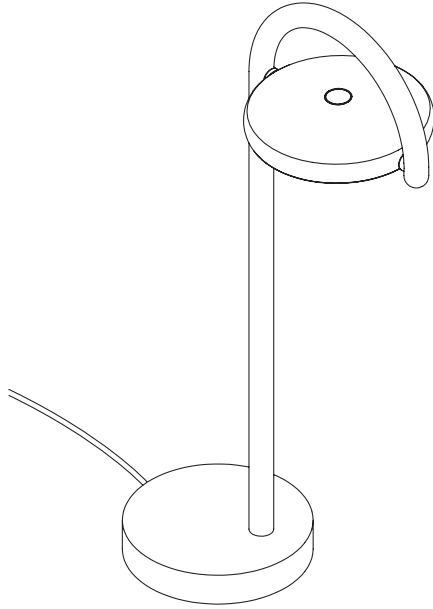

Lamp

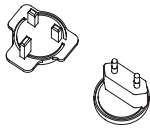

Adapter

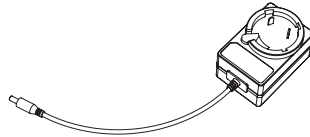

Power supply

1.

Unpack all the parts and check that you have received all the parts listed. There is no assembly required for either of these lamps.

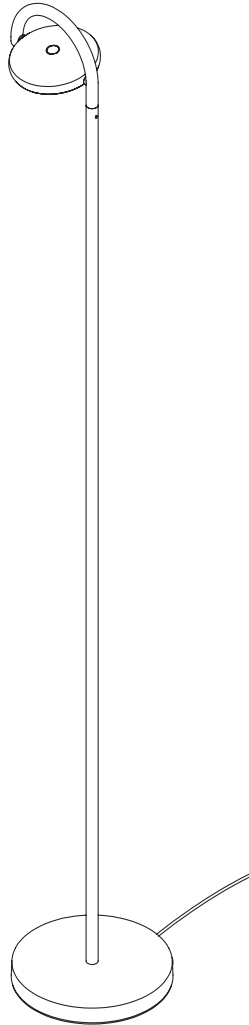
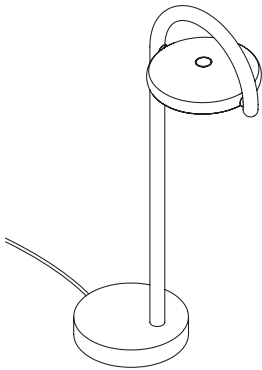

2.

The lamp's head can tilt 180 degrees either way in order to direct the light sideways or downwards.

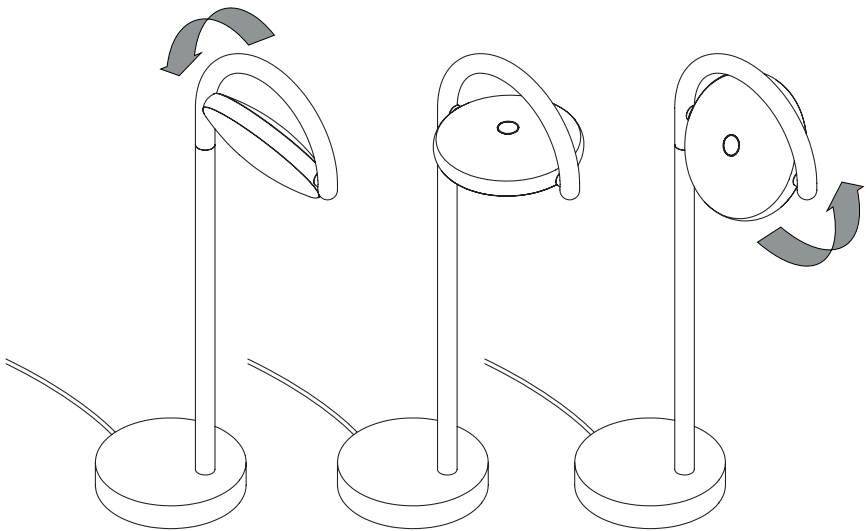

3.

The lamp's head can also be rotated almost 360 degrees around its upright.

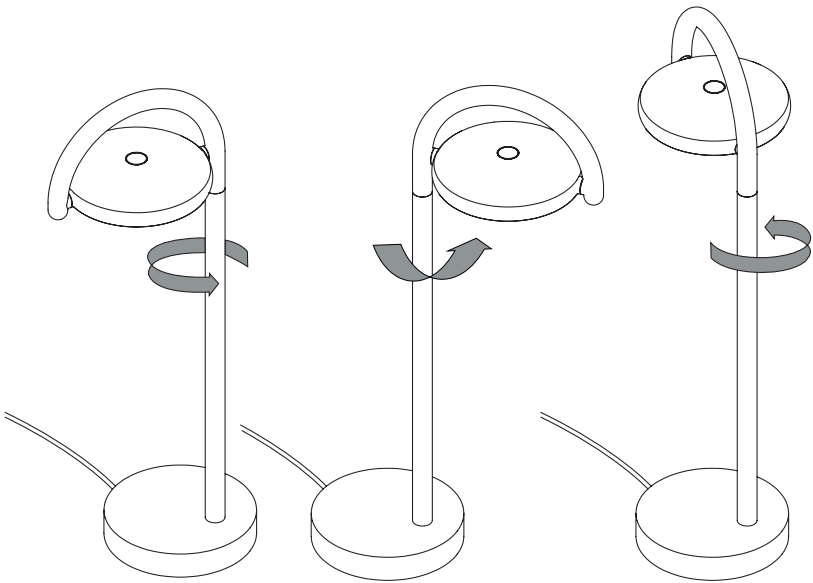

4.

A touch sensitive step dimming switch is located on the backside of the lamp's light source.

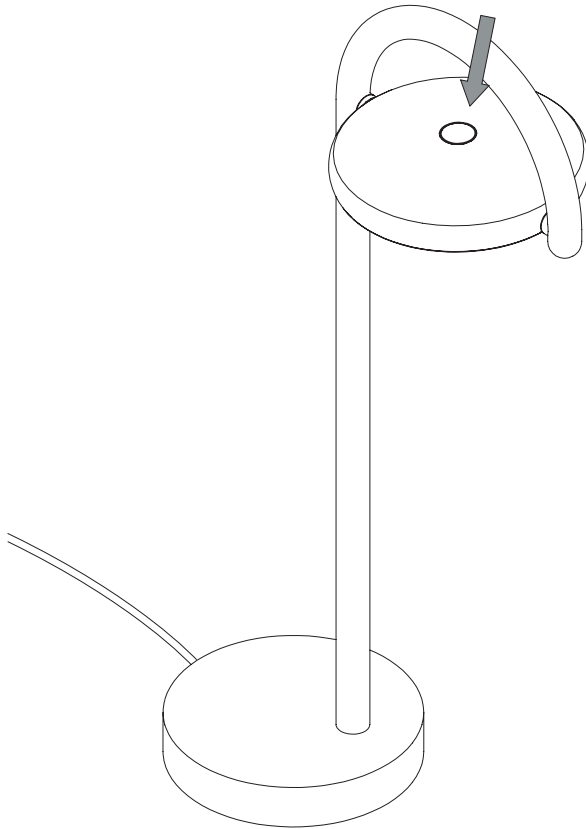

5.

Plug the trailing cable into the power supply.
Attach the correct adapter for your region.
The lamp is now ready for use.

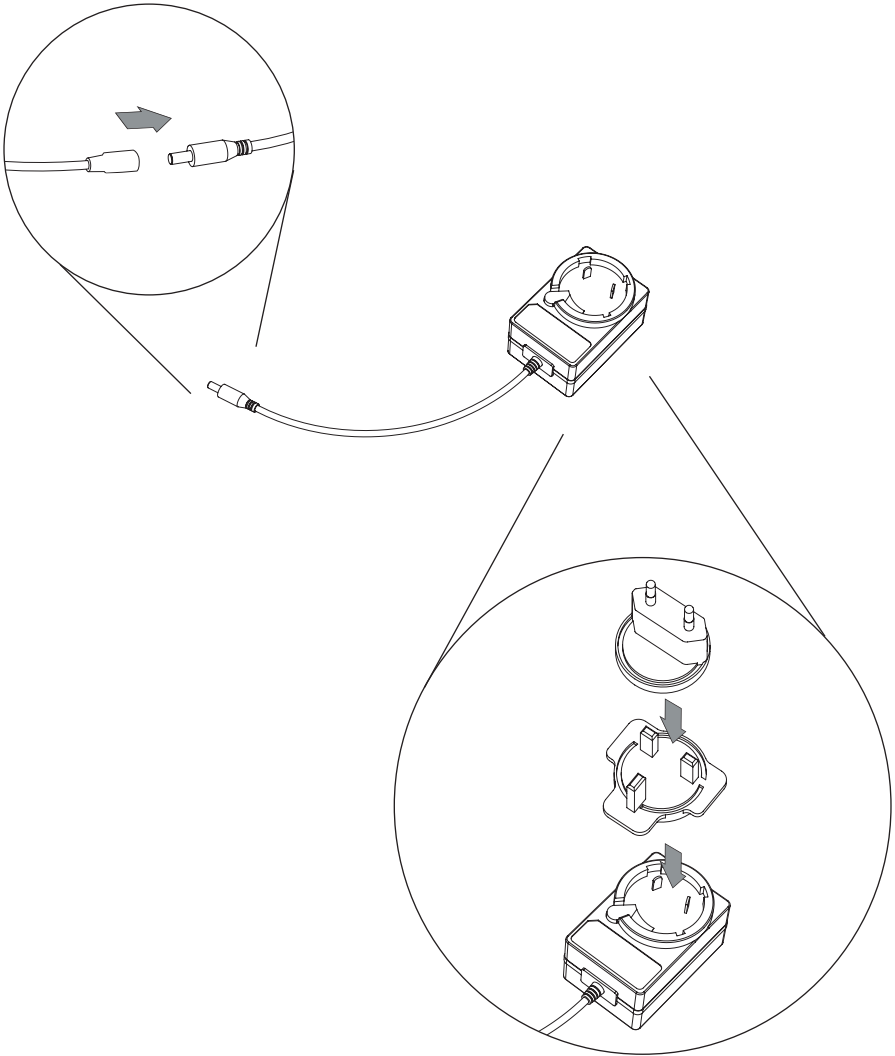

- CARE & MAINTENANCE -

Our Care & Maintenance offers guidance for optimal maintenance of your HAY product. It includes advice and instructions on cleaning and caring for specific materials to prolong the life of your lighting.



Please find our Care & Maintenance guide by scanning the QR code



You can find more relevant information on Marselis Collection by scanning the QR code

You can also find the same information here
hay.dk/downloads

Havnen 1 8700 Horsens Denmark
+45 4282 0282 / hay@hay.com

www.hay.com

21/12/2021

HAY