

Instructions

Bonnet SC91-SC93 Space Copenhagen 2024

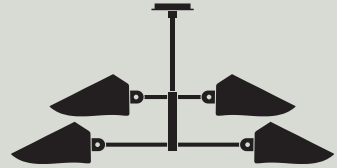

Please read these instructions carefully and retain them for future reference to ensure the product is used correctly. For your own safety, please study each step of this instruction manual first. &Tradition is not responsible for any faults or damage caused by not following these instructions correctly. Do not modify this product in any way. If you have any questions or comments, please do not hesitate to contact us by mail on: info@andtradition.com

&Tradition®

Bonnet SC91-SC93

Space Copenhagen

2024

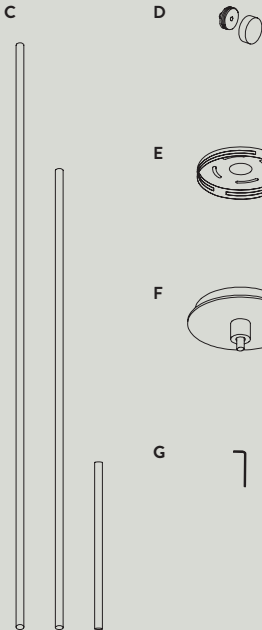
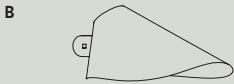
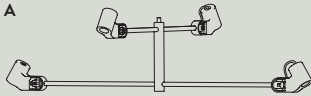

12/23

For indoor use only
4xE27 Maximum 25W
Bulb not included

Safety precautions

- Dispose of plastic bag from packaging and do not allow children to play with it.
- Keep product well out of children's reach.
- The lamp is only intended for interior use.
- Consult a professionally qualified electrician if in any doubt.
- If the external cable or cord of this lamp is damaged, it must be replaced by the manufacture or a similar qualified person in order to avoid a hazard.

Contents

- A Lamp body
- B 4 x lamp shades
- C Stem (1 x stem included)
- D 8 x screws incl. screw caps for the shade
- E Ceiling bracket
- F Canopy
- G Allen key

Tools needed

- 4 x E27 light bulb
- Screwdriver

Cleaning instructions

- Wipe surface of lamp shade with a soft, damp sponge or cloth.
- Do not use any abrasive cleaning tools such as steel wool, scouring sponges or stiff brushes.
- Never use strong cleaning agents such as white spirit, turpentine, household glass cleaner or cellulose thinners.
- Only wipe the inside of the shade with a soft, damp cloth or feather duster.

For standard installation please follow step 1 – 13

Step 1 / 13

Ensure power supply is turned off and remove any existing lamp fitting.
Locate the supply cable and ensure it is ready to be fitted to the connector block.
Mount the ceiling bracket securely in the ceiling with screws and wall plugs, appropriate for the ceiling of installation.

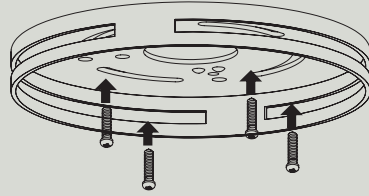

Step 2 / 13

To install the shades, pass them over the socket. Make sure the squared cut outs on the shade fits with the corresponding squares on the sockets.

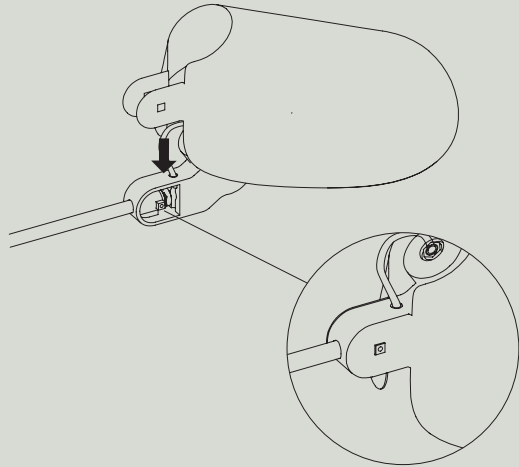

Step 3 / 13

Press the shades together to ensure that they do not move while attaching the screws.
When the screws are properly tightened using the allen key, screw on the screw caps.

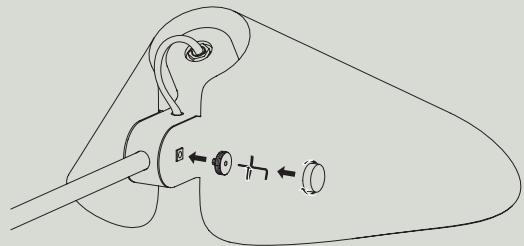

Step 4 / 13

Take the cord coming out of the lamp body (A), and pass it through the stem (C). Screw on the stem to the lamp body.

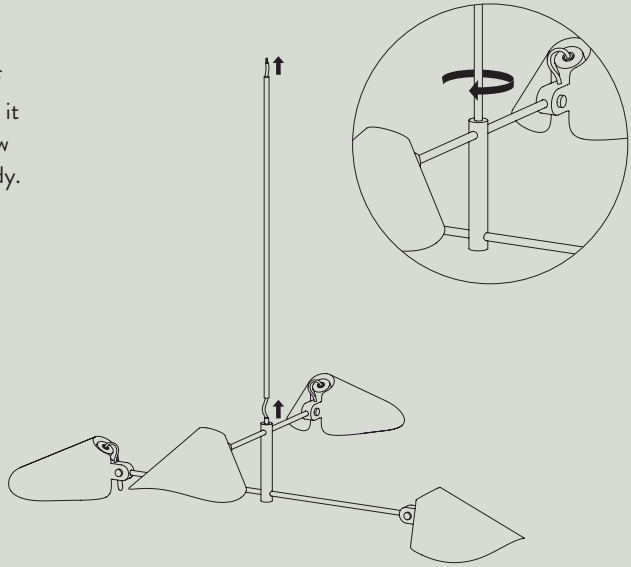

Step 5 / 13

Pass the cord through the canopy, and screw on the canopy.

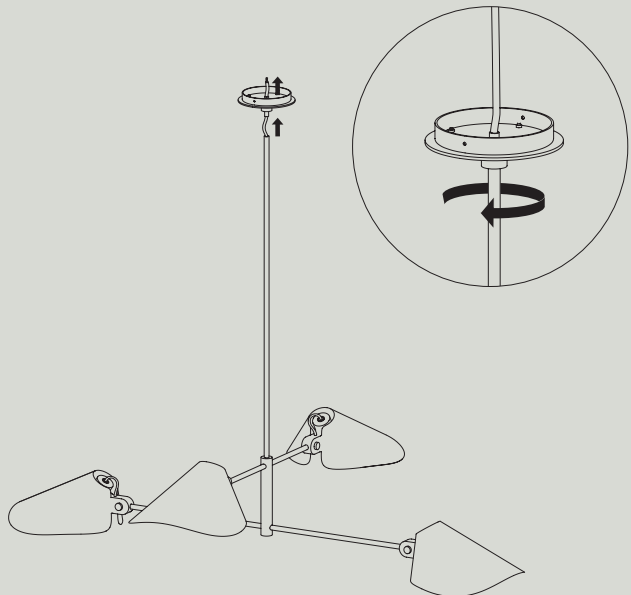

Step 6 / 13

Tighten the two small screws at the top and bottom of the stem to fix it in place.

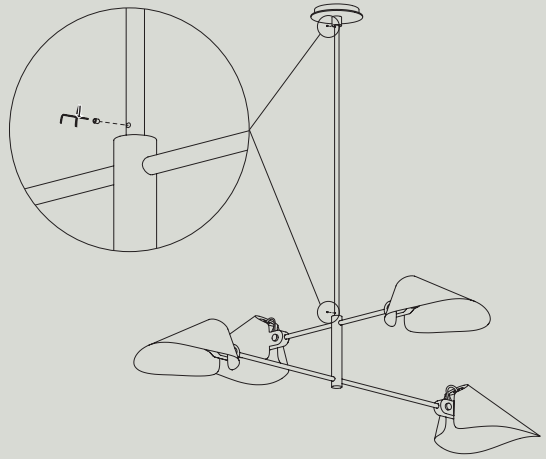

Step 7 / 13

Pass the cord through the plastic strain relief, and tighten it, using the two screws.

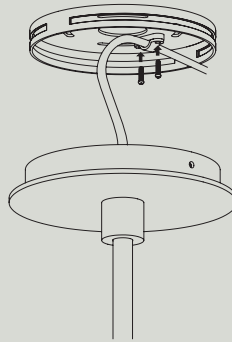

Step 8 / 13

Use the terminal box inside the connection box to assemble the wires from the lamp with the wires from the power supply. Close the connection box and place it inside the canopy. Connect according to the L/N markings on the terminal blocks

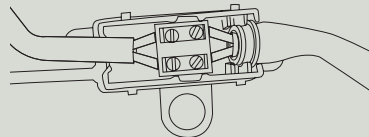

Step 9 / 13

Install the canopy onto the metal bracket, and screw on to keep it in place. Do not fully tighten them yet.

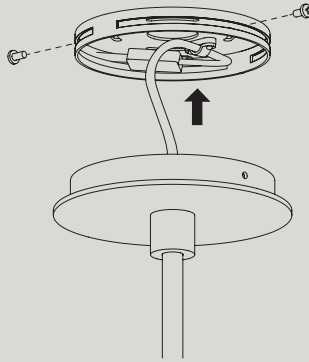

Step 10 / 13

If needed, adjust the position of the lamp, by turning the lamp at the canopy. Do not turn it using the stem.

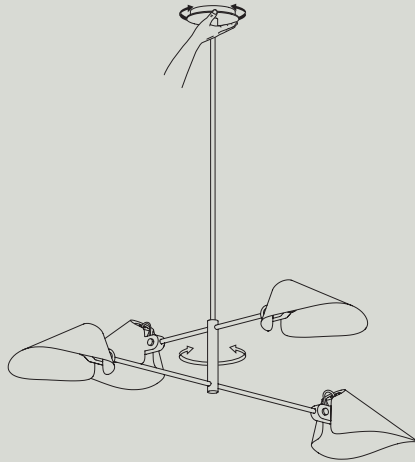

Step 11 / 13

When the lamp is in the desired position tighten the screws at the canopy.

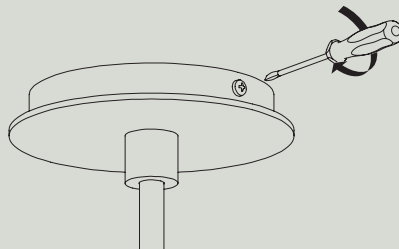

Step 12 / 13

Install the light bulbs.

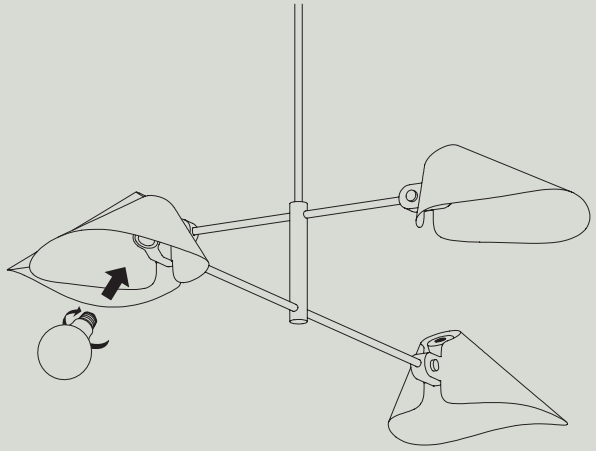

Step 13 / 13

The shades can be turned by holding onto the base of the sockets and rotating the shade. It is not recommended to turn the shades by holding onto the shades, to keep the shape of the shades intact. Be aware that the shades can only turn 180 degrees in one direction.

