



### Safety Instructions

1, 2, 3, 4, 7, 9, 11, 12, 13, 14, 16, 17, 18, 19, 21, 33, 34



Info

[www.paulmann.com](http://www.paulmann.com)

Paulmann Licht GmbH  
Quezinger Feld 2  
31832 Springe  
Germany

[www.paulmann.com](http://www.paulmann.com)

Art.-Nr. : 709.63  
709.64

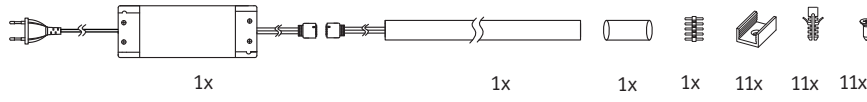

709.63

1x

1x

1x

1x

11x

11x

11x

(+326)PPN 11/18

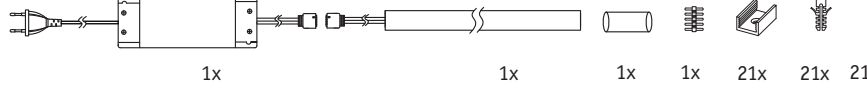

709.64

1x

1x

1x

1x

21x

21x

21x



A1 A2



Safety Instructions  
Nr. 7, 10

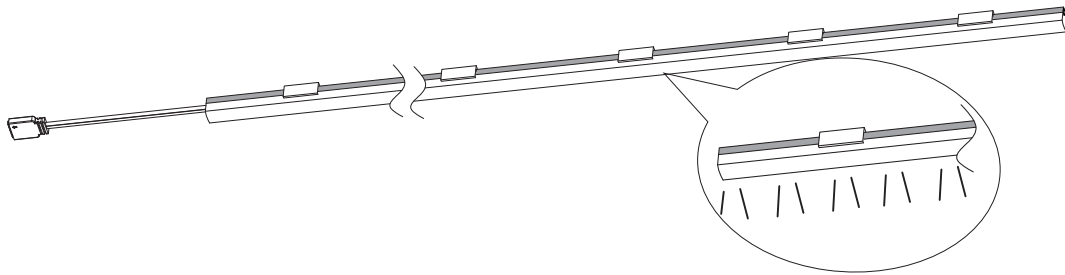
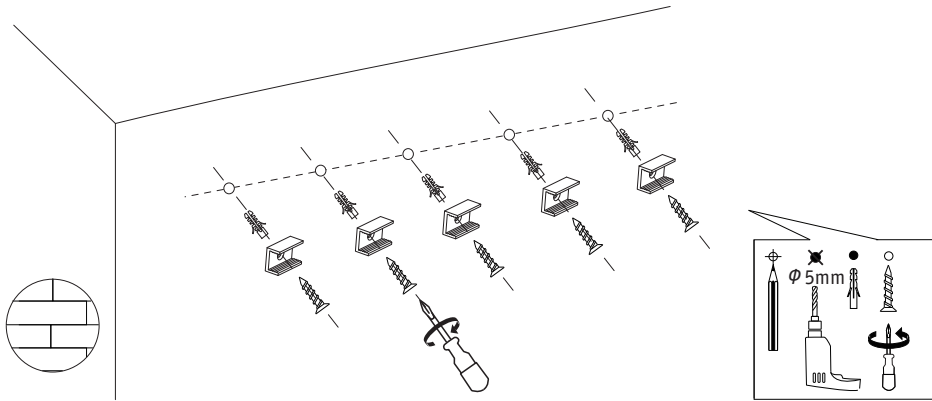

A1 A2



Safety Instructions  
Nr. 7, 10

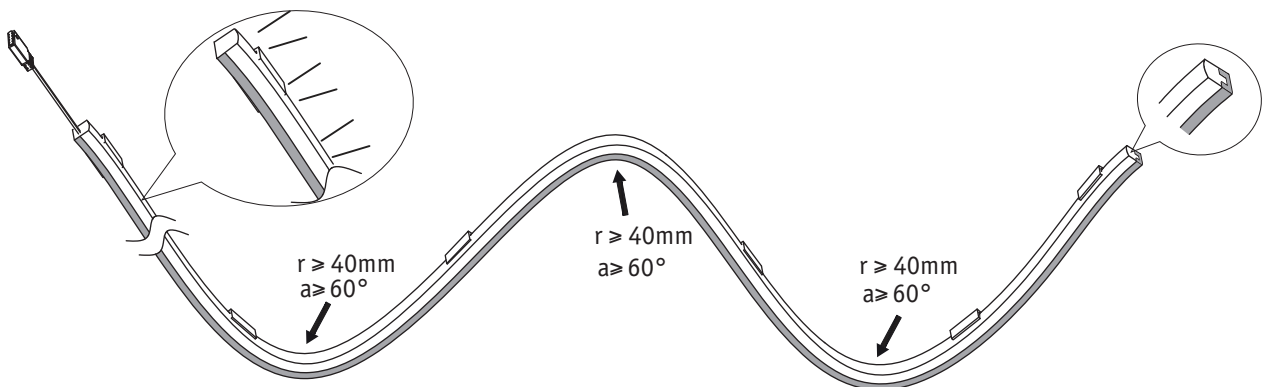
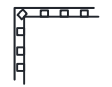
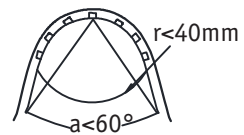
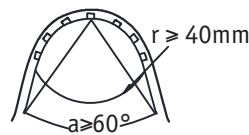
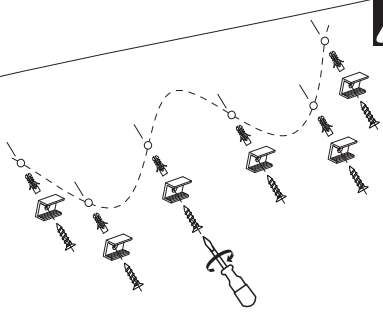

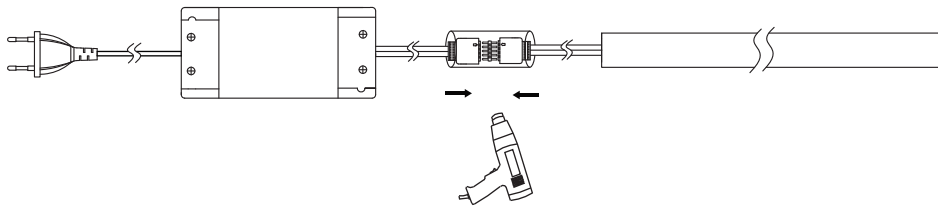

IP20

IP44

IP67

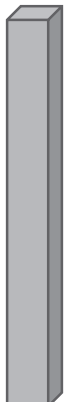
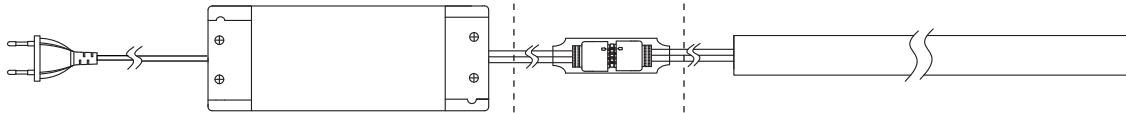

Off

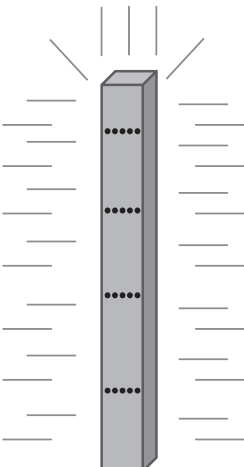

On

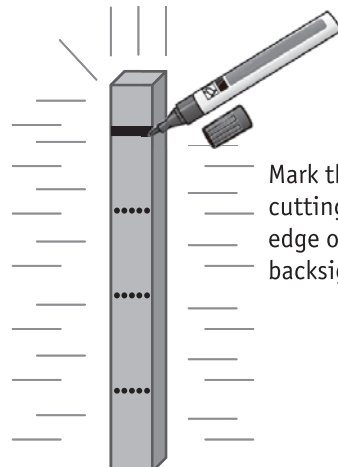

On



Mark the cutting edge on the backside



Off



Cuttable every 3,3cm

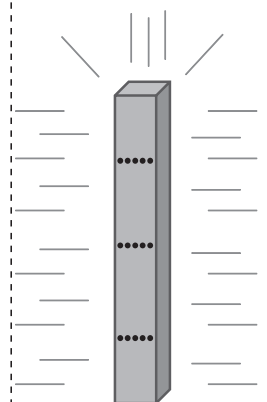

On

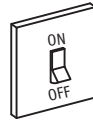

IP20

